

PHILCO®

PBU1153 A

en
chs

Instruction Manual
冰箱使用说明书



Please read this user manual first!

Dear Customer,

We hope that your product, which has been produced in modern plants and checked under the most meticulous quality control procedures, will provide you an effective service.

Therefore, read this entire user manual carefully before using the product and keep it as a reference. If you handover the product to someone else, give the user manual as well.

The user manual will help you use the product in a fast and safe way.

- Read the manual before installing and operating the product.
- Make sure you read the safety instructions.
- Keep the manual in an easily accessible place as you may need it later.
- Read the other documents given with the product.

Remember that this user manual is also applicable for several other models. Differences between models will be identified in the manual.

Explanation of symbols

Throughout this user manual the following symbols are used:

 Important information or useful tips.

 Warning against dangerous conditions for life and property.

 Warning against electric voltage.

CONTENTS

1 Your refrigerator	4	4 Preparation	17
2 Important Safety Warnings	5	5 Using your refrigerator	18
Intended use	5	Thermostat setting button.....	18
General safety	6	Cooling.....	19
For products with a	10	Freezing.....	19
water dispenser;.....	10	Defrost	19
Child safety.....	10	Stopping your product.....	20
Compliance with WEEE Directive and Disposing of the Waste Product:	11	6 Maintenance and cleaning	21
Package information.....	11	Protection of plastic surfaces	21
HC warning	11	7 Troubleshooting	22
Things to be done for energy saving	12		
3 Installation	13		
Points to be paid attention to when the relocation of the refrigerator	13		
Electrical connection.....	13		
Disposing of the packaging	14		
Disposing of your old refrigerator	14		
Placing and Installation	14		
Changing the illumination lamp	15		
Reversing the doors	16		

1 Your refrigerator

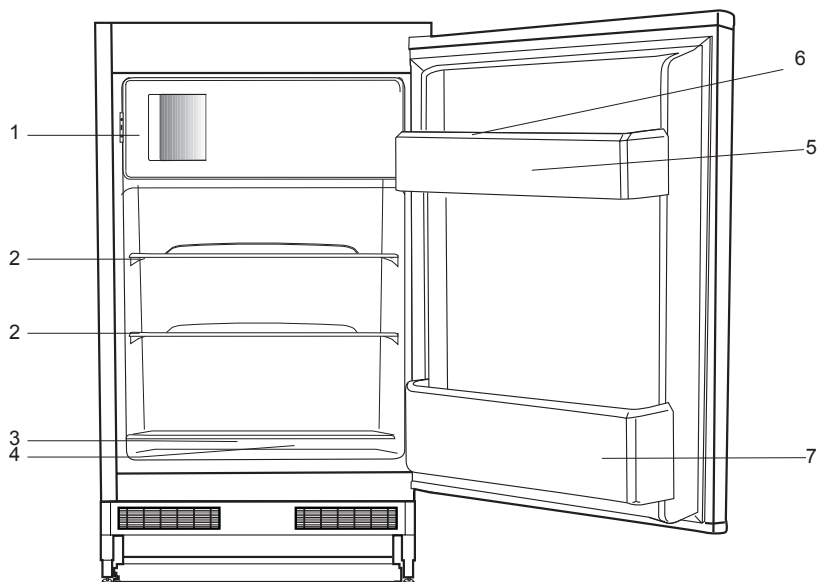





1. To freeze fresh food, frozen food, rapid cooling of beverages, making ice cubes.
2. Baked, chilled cooked food, dairy products.
3. Meat, sausages, cold cuts, cans.
4. Fruit, vegetables, salads.
5. Tubes, small bottles and cans.
6. Egg tray.
7. Beverages, large bottles.

i Figures that take place in this instruction manual are schematic and may not correspond exactly with your product. If the subject parts are not included in the product you have purchased, then it is valid for other models.

This section provides the safety instructions necessary to prevent the risk of injury and material damage. Failure to observe these instructions will invalidate all types of product warranty.

Intended use

	<p>WARNING:</p> <p>Keep ventilation openings, in the appliance enclosure or in the built-in structure, clear of obstruction.</p>
	<p>WARNING:</p> <p>Do not use mechanical devices or other means to accelerate the defrosting process, other than those recommended by the manufacturer.</p>
	<p>WARNING:</p> <p>Do not damage the refrigerant circuit.</p>
	<p>WARNING:</p> <p>Do not use electrical appliances inside the food storage compartments of the appliance, unless they are of the type recommended by the manufacturer.</p>
	<p>WARNING:</p> <p>Do not store explosive substances such as aerosol cans with a flammable propellant in this appliance.</p>

This appliance is intended to be used in household and similar applications such as

- staff kitchen areas in shops, offices and other working environments;

- farm houses and by clients in hotels, motels and other residential type environments;

- bed and breakfast type environments;
- catering and similar non-retail applications.

General Safety

- This product should not be used by persons with physical, sensory and mental disabilities, without sufficient knowledge and experience or by children. The device can only be used by such persons under supervision and instruction of a person responsible for their safety. Children should not be allowed to play with this device.
- In case of malfunction, unplug the device.
- After unplugging, wait at least 5 minutes before plugging in again.
- Unplug the product when not in use.
- Do not touch the plug with wet hands! Do not pull the cable to plug off, always hold the plug.
- Do not plug in the refrigerator if the socket is loose.
- Unplug the product during installation, maintenance, cleaning and repair.
- If the product will not be used for a while, unplug the product and remove any food inside.
- Do not use the product when the compartment with circuit cards located on the upper back part of the product (electrical card box cover) (1) is open.

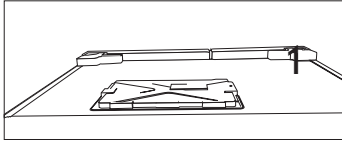
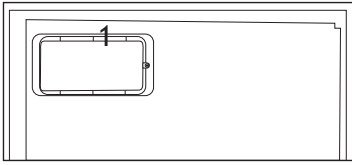

- Do not use steam or steamed cleaning materials for cleaning the refrigerator and melting the ice inside. Steam may contact the electrified areas and cause short circuit or electric shock!
- Do not wash the product by spraying or pouring water on it! Danger of electric shock!
- In case of malfunction, do not use the product, as it may cause electric shock. Contact the authorized service before doing anything.
- Plug the product into an earthed socket. Earthing must be done by a qualified electrician.
- If the product has LED type lighting, contact the authorized service for replacing or in case of any problem.
- Do not touch frozen food with wet hands! It may adhere to your hands!
- Do not place liquids in bottles and cans into the freezer compartment. They may burst out!
- Place liquids in upright position after tightly closing the lid.
- Do not spray flammable substances near the product, as it may burn or explode.

- Do not keep flammable materials and products with flammable gas (sprays, etc.) in the refrigerator.
- Do not place containers holding liquids on top of the product. Splashing water on an electrified part may cause electric shock and risk of fire.
- Exposing the product to rain, snow, sunlight and wind will cause electrical danger. When relocating the product, do not pull by holding the door handle. The handle may come off.
- Take care to avoid trapping any part of your hands or body in any of the moving parts inside the product.
- Do not step or lean on the door, drawers and similar parts of the refrigerator. This will cause the product to fall down and cause damage to the parts.
- Take care not to trap the power cable.

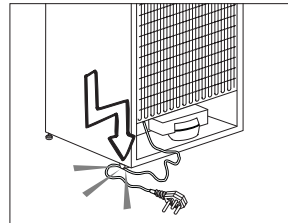

- When positioning the appliance, ensure the supply cord is not trapped or damaged.
- Do not locate multiple portable socket-outlets or portable power supplies at the rear of the appliance.
- Children aged from 3 to 8 years are allowed to load and unload refrigerating appliances.

- To avoid contamination of food, please respect the following instructions:
- – Opening the door for long periods can cause a significant increase of the temperature in the compartments of the appliance.
- – Clean regularly surfaces that can come in contact with food and accessible drainage systems.
- – Clean water tanks if they have not been used for 48 h; flush the water system connected to a water supply if water has not been drawn for 5 days.
- – Store raw meat and fish in suitable containers in the refrigerator, so that it is not in contact with or drip onto other food.
- – Two-star frozen-food compartments are suitable for storing pre-frozen food, storing or making icecream and making ice cubes.
- – One-, two- and three-star compartments are not suitable for the freezing of fresh food.
- – If the refrigerating appliance is left empty for long periods, switch off, defrost, clean, dry, and leave the door open to prevent mould developing within the appliance.

1.1.1 HC Warning

If the product comprises a cooling system using R600a gas, take care to avoid damaging the cooling system and its pipe while using and moving the product. This gas is flammable. If the cooling system is damaged, keep the product away from sources of fire and ventilate the room immediately.



The label on the inner left side indicates the type of gas used in the product.

1.1.2 For Models with Water Dispenser

- Pressure for cold water inlet shall be maximum 90 psi (6.2 bar). If your water pressure exceeds 80 psi (5.5 bar), use a pressure limiting valve in your mains system. If you do not know how to check your water pressure, ask for the help of a professional plumber.
- If there is risk of water hammer effect in your installation, always use a water hammer prevention equipment in your installation. Consult Professional plumbers if you are not sure that there is no water hammer effect in your installation.
- Do not install on the hot water inlet. Take precautions against of the risk of freezing of the hoses. Water temperature operating interval shall be 33°F (0.6°C) minimum and 100°F (38°C) maximum.
- Use drinking water only.

Intended Use

- This product is designed for home use. It is not intended for commercial use.
- The product should be used to store food and beverages only.
- Do not keep sensitive products requiring controlled temperatures (vaccines, heat sensitive medication, medical supplies, etc.) in the refrigerator.

- The manufacturer assumes no responsibility for any damage due to misuse or mishandling.
- Original spare parts will be provided for 10 years, following the product purchasing date.

Child Safety

- Keep packaging materials out of children's reach.
- Do not allow the children to play with the product.
- If the product's door comprises a lock, keep the key out of children's reach.

Compliance with WEEE Directive and Disposing of the Waste Product

This product complies with EU WEEE Directive (2012/19/EU). This product bears a classification symbol for waste electrical and electronic equipment (WEEE).

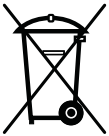

This product has been manufactured with high quality parts and materials which can be reused and are suitable for recycling.

Do not dispose of the waste product with normal domestic and other wastes at the end of its service life. Take it to the collection center for the recycling of electrical and electronic equipment. Please consult your local authorities to learn about these collection centers.

Compliance with RoHS Directive

- This product complies with EU WEEE Directive (2011/65/EU). It does not contain harmful and prohibited materials specified in the Directive.

Package Information

Packaging materials of the product are manufactured from recyclable materials in accordance with our National Environment Regulations. Do not dispose of the packaging materials together with the domestic or other wastes. Take them to the packaging material collection points designated by the local authorities.

3 Installation

⚠ In case the information which are given in the user manual are not taken into account, manufacturer will not assume any liability for this.

Points to be paid attention to when the relocation of the refrigerator

1. Your refrigerator should be unplugged. Before transportation of your refrigerator, it should be emptied and cleaned.

2. Before it is re-packaged, shelves, accessories, crisper, etc. inside your refrigerator should be fixed with adhesive tape and secured against impacts. Package should be bound with a thick tape or sound ropes and the transportation rules on the package should be strictly observed.

3. Original packaging and foam materials should be kept for future transportations or moving.

Before you start the refrigerator,

Check the following before you start to use your refrigerator:

1. Attach 2 plastic wedges as illustrated below. Plastic wedges are intended to keep the distance which will ensure the air circulation between your refrigerator and the wall. (The picture is drawn up as a representation and it is not identical with your product.)

2. Clean the interior of the refrigerator as recommended in the "Maintenance and cleaning" section.

3. Connect the plug of the refrigerator to the wall socket. When the fridge door is opened, fridge internal lamp will turn on.

4. When the compressor starts to operate, a sound will be heard. The liquid and gases sealed within the refrigeration system may also give rise to noise, even if the compressor is not running and this is quite normal.

5. Front edges of the refrigerator may feel warm. This is normal. These areas are designed to be warm to avoid condensation.

Electrical connection

Connect your product to a grounded socket which is being protected by a fuse with the appropriate capacity.

Important:

The connection must be in compliance with national regulations.

- The power plug must be easily accessible after installation.
- Electrical safety of your refrigerator shall be guaranteed only if the earth system in your house complies with standards.
- The voltage stated on the label located at left inner side of your product should be equal to your network voltage.
- Extension cables and multi plugs must not be used for connection.

⚠ A damaged power cable must be replaced by a qualified electrician.

⚠ Product must not be operated before it is repaired! There is the risk of electric shock!

Disposing of the packaging

The packing materials may be dangerous for children. Keep the packing materials out of the reach of children or dispose of them by classifying them in accordance with the waste instructions stated by your local authorities. Do not throw away with regular house waste, throw away on packaging pick up spots designated by the local authorities.

The packing of your refrigerator is produced from recyclable materials.

Disposing of your old refrigerator

Dispose of your old refrigerator without giving any harm to the environment.

- You may consult your authorized dealer or waste collection center of your municipality about the disposal of your refrigerator.

Before disposing of your refrigerator, cut out the electric plug and, if there are any locks on the door, make them inoperable in order to protect children against any danger.

Placing and Installation

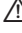
 If the entrance door of the room where the refrigerator will be installed is not wide enough for the refrigerator to pass through, then call the authorized service to have them remove the doors of your refrigerator and pass it sideways through the door.

1. Install your refrigerator to a place that allows ease of use.
2. Keep your refrigerator away from heat sources, humid places and direct sunlight.
3. There must be appropriate air ventilation around your refrigerator in order to achieve an efficient operation. If the refrigerator is to be placed in a recess in the wall, there must be at least 5 cm distance with the ceiling and at least 5 cm with the wall. Do not place your product on the materials such as rug or carpet.
4. Place your refrigerator on an even floor surface to prevent jolts.

Changing the illumination lamp

To change the Bulb/LED used for illumination of your refrigerator, call your AuthorisedService.

The lamp(s) used in this appliance is not suitable for household room illumination. The intended purpose of this lamp is to assist the user to place foodstuffs in the refrigerator/freezer in a safe and comfortable way. The lamps used in this appliance have to withstand extreme physical conditions such as temperatures below -20 °C.

(only chest and upright freezer)

Reversing the doors

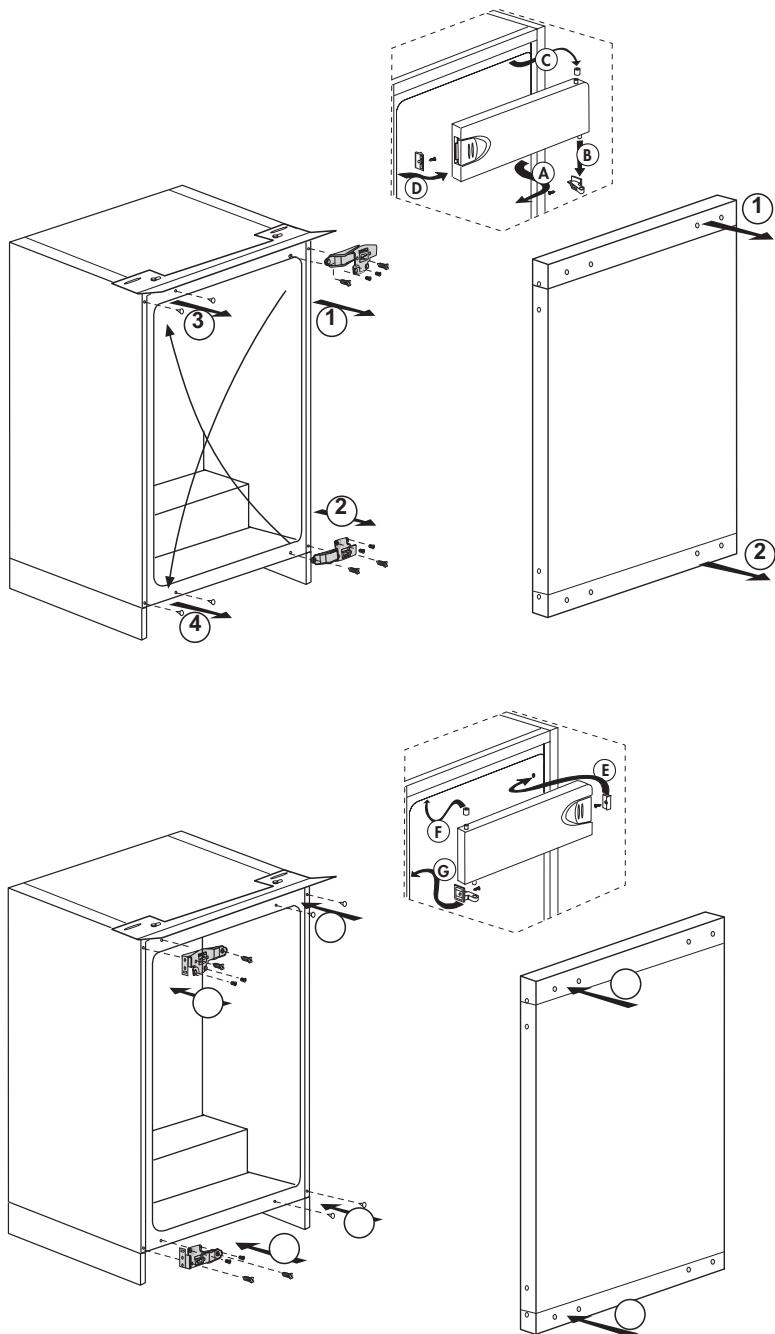

4 Preparation

- Your refrigerator should be installed at least 30 cm away from heat sources such as hobs, ovens, central heater and stoves and at least 5 cm away from electrical ovens and should not be located under direct sunlight.
- The ambient temperature of the room where you install your refrigerator should at least be 5°C. Operating your refrigerator under cooler conditions is not recommended with regard to its efficiency.
- Please make sure that the interior of your refrigerator is cleaned thoroughly.
- If two refrigerators are to be installed side by side, there should be at least 2 cm distance between them.
- When you operate your refrigerator for the first time, please observe the following instructions during the initial six hours.
- The door should not be opened frequently.
- It must be operated empty without any food in it.
- Do not unplug your refrigerator. If a power failure occurs out of your control, please see the warnings in the "Recommended solutions for the problems" section.
- Original packaging and foam materials should be kept for future transportations or moving.
- The baskets/drawers that are provided with the chill compartment must always be in use for low energy consumption and for better storage conditions.
- Food contact with the temperature sensor in the freezer compartment may increase energy consumption of the appliance. Thus any contact with the sensor(s) must be avoided.
- In some models, the instrument panel automatically turns off 5 minutes after the door has closed. It will be reactivated when the door has opened or pressed on any key.
- Due to temperature change as a result of opening/closing the product door during operation, condensation on the door/body shelves and the glass containers is normal

5 Using your refrigerator

Thermostat setting button

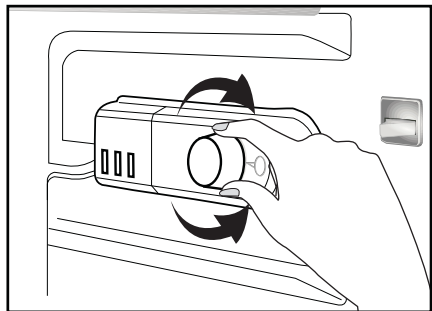

The operating temperature is regulated by the temperature control.

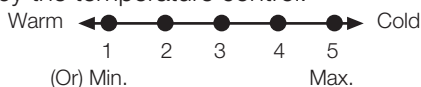

**1 = Lowest cooling setting
(Warmest setting)**

**5 = Highest cooling setting
(Coldest setting)**

(Or)

**Min. = Lowest cooling setting
(Warmest setting)**

**Max. = Highest cooling setting
(Coldest setting)**

The average temperature inside the fridge should be around +5°C.

Please choose the setting according to the desired temperature.

Please note that there will be different temperatures in the cooling area.

The coldest region is immediately above the vegetable compartment.

The interior temperature also depends on ambient temperature, the frequency with which the door is opened and the amount of foods kept inside.

Frequently opening the door causes the interior temperature to rise.

For this reason, it is recommended to close the door again as soon as possible after use.

The interior temperature of your refrigerator changes for the following reasons;

- Seasonal temperatures,
- Frequent opening of the door and leaving the door open for long periods,
- Food put into the refrigerator without cooling down to the room temperature,
- The location of the refrigerator in the room (e.g. exposing to sunlight).
- You may adjust the varying interior temperature due to such reasons by using the thermostat. Numbers around the thermostat button indicates the cooling degrees.
- If the ambient temperature is higher than 32°C, turn the thermostat button to maximum position.
- If the ambient temperature is lower than 25°C, turn the thermostat button to minimum position.

Cooling

Food storage

The fridge compartment is for the short-term storage of fresh food and drinks.

Freezing

Freezing food

The freezing compartment is marked with  this symbol.

You can use the appliance for freezing fresh food as well as for storing pre-frozen food.

Please refer to the recommendations given on the packaging of your food.

Storing frozen food

The frozen food compartment is marked with  symbol.

The frozen food compartment is suitable for the storage of pre-frozen food. The recommendation for storage, as stated on the food packaging, should be observed at all times.

Defrost

A) Fridge compartment

Fridge compartment performs full-automatic defrosting. Water drops and a frosting up to 7-8 mm can occur on the inner rear wall of the fridge compartment while your refrigerator cools down. Such formation is normal as a result of the cooling system. The frost formation is defrosted by performing automatic defrosting with certain intervals thanks to the automatic defrosting system of the rear wall. User is not required to scrape the frost or remove the water drops.

Water resulting from the defrosting passes from the water collection groove and flows into the evaporator through the drain pipe and evaporates here by itself.

Check regularly to see if the drain pipe is clogged or not and clear it with the stick in the hole when necessary.

Deep freezer compartment does not perform automatic defrosting in order to prevent decaying of the frozen food.

B) Freezer compartment

Defrosting is very straightforward and without mess, thanks to a special defrost collection basin.

Defrost twice a year or when a frost layer of around 7 (1/4") mm has formed.

To start the defrosting procedure, switch off the appliance at the socket outlet and pull out the mains plug.

All food should be wrapped in several layers of newspaper and stored in a cool place (e.g. fridge or larder).

Containers of warm water may be placed carefully in the freezer to speed up the defrosting.

Do not use pointed or sharp-edged objects, such as knives or forks to remove the frost.

Never use hair dryers, electrical heaters or other such electrical appliances for defrosting.

Sponge out the defrost water collected in the bottom of the freezer compartment. After defrosting, dry the interior thoroughly.

Insert the plug into the wall socket and switch on the electricity supply.

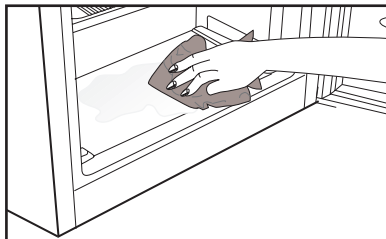

Stopping your product

If your thermostat is equipped with "0" position:

- Your product will stop operating when you turn the thermostat button to "0" (zero) position. Your product will not start unless to you turn the thermostat button to position "1" or one of the other positions again.

If your thermostat is equipped with "min" position:

- Unplug your product to stop it.

6 Maintenance and cleaning

- ⚠ Never use gasoline, benzene or similar substances for cleaning purposes.
- ⚠ We recommend that you unplug the appliance before cleaning.
- ⚠ Never use any sharp abrasive instrument, soap, household cleaner, detergent and wax polish for cleaning.
- ℹ Use lukewarm water to clean the cabinet of your refrigerator and wipe it dry.
- ℹ Use a damp cloth wrung out in a solution of one teaspoon of bicarbonate of soda to one pint of water to clean the interior and wipe it dry.
- ⚠ Make sure that no water enters the lamp housing and other electrical items.
- ⚠ If your refrigerator is not going to be used for a long period of time, unplug the power cable, remove all food, clean it and leave the door ajar.
- ℹ Check door seals regularly to ensure they are clean and free from food particles.
- ⚠ To remove door racks, remove all the contents and then simply push the door rack upwards from the base.
- ⚠ Never use cleaning agents or water that contain chlorine to clean the outer surfaces and chromium coated parts of the product. Chlorine causes corrosion on such metal surfaces.
- ⚠ Do not use sharp, abrasive tools, soap, household cleaning agents, detergents, kerosene, fuel oil, varnish etc. to prevent removal and deformation of the prints on the plastic part. Use lukewarm water and a soft cloth for cleaning and then wipe it dry.

Protection of plastic surfaces

- ℹ Do not put the liquid oils or oil-cooked meals in your refrigerator in unsealed containers as they damage the plastic surfaces of your refrigerator. In case of spilling or smearing oil on the plastic surfaces, clean and rinse the relevant part of the surface at once with warm water.

7 Troubleshooting

Please review this list before calling the service. It will save your time and money. This list includes frequent complaints that are not arising from defective workmanship or material usage. Some of the features described here may not exist in your product.

The refrigerator does not operate.

- The plug is not inserted into the socket correctly. >>>Insert the plug into the socket securely.
- The fuse of the socket which your refrigerator is connected to or the main fuse have blown out. >>>Check the fuse.

Condensation on the side wall of the fridge compartment (MULTIZONE, COOL CONTROL and FLEXI ZONE).

- Door has been opened frequently. >>>Do not open and close the door of refrigerator frequently.
- Ambient is very humid. >>>Do not install your refrigerator into highly humid places.
- Food containing liquid is stored in open containers. >>>Do not store food with liquid content in open containers.
- Door of the refrigerator is left ajar. >>>Close the door of the refrigerator.
- Thermostat is set to a very cold level. >>>Set the thermostat to a suitable level.

Compressor is not running

- Protective thermic of the compressor will blow out during sudden power failures or plug-out plug-ins as the refrigerant pressure in the cooling system of the refrigerator has not been balanced yet. The refrigerator will start running approximately after 6 minutes. Please call the service if the refrigerator does not startup at the end of this period.
- The fridge is in defrost cycle. >>>This is normal for a full-automatically defrosting refrigerator. Defrosting cycle occurs periodically.
- The refrigerator is not plugged into the socket. >>>Make sure that the plug is fit into the socket.
- Temperature settings are not made correctly. >>>Select the suitable temperature value.
- There is a power outage. >>>Refrigerator returns to normal operation when the power restores.

The operation noise increases when the refrigerator is running.

- The operating performance of the refrigerator may change due to the changes in the ambient temperature. It is normal and not a fault.

The refrigerator is running frequently or for a long time.

- New product may be wider than the previous one. Larger refrigerators operate for a longer period of time.
- The room temperature may be high. >>>It is normal that the product operates for longer periods in hot ambient.
- The refrigerator might be plugged in recently or might be loaded with food. >>>When the refrigerator is plugged in or loaded with food recently, it will take longer for it to attain the set temperature. This is normal.
- Large amounts of hot food might be put in the refrigerator recently. >>>Do not put hot food into the refrigerator.
- Doors might be opened frequently or left ajar for a long time. >>>The warm air that has entered into the refrigerator causes the refrigerator to run for longer periods. Do not open the doors frequently.
- Freezer or fridge compartment door might be left ajar. >>>Check if the doors are closed completely.
- The refrigerator is adjusted to a very low temperature. >>>Adjust the refrigerator temperature to a warmer degree and wait until the temperature is achieved.
- Door seal of the fridge or freezer may be soiled, worn out, broken or not properly seated. >>>Clean or replace the seal. Damaged/broken seal causes the refrigerator to run for a longer period of time in order to maintain the current temperature.

Freezer temperature is very low while the fridge temperature is sufficient.

- The freezer temperature is adjusted to a very low value. >>>Adjust the freezer temperature to a warmer degree and check.

Fridge temperature is very low while the freezer temperature is sufficient.

- The fridge temperature is adjusted to a very low value. >>>Adjust the fridge temperature to a warmer degree and check.

Food kept in the fridge compartment drawers is frozen.

- The fridge temperature is adjusted to a very high value. >>>Adjust the fridge temperature to a lower value and check.

Temperature in the fridge or freezer is very high.

- The fridge temperature is adjusted to a very high value. >>>Fridge compartment temperature setting has an effect on the temperature of the freezer. Change the temperatures of the fridge or freezer and wait until the relevant compartments attain a sufficient temperature.
- Doors are opened frequently or left ajar for a long time. >>>Do not open the doors frequently.
- Door is ajar. >>>Close the door completely.
- The refrigerator is plugged in or loaded with food recently. >>>This is normal. When the refrigerator is plugged in or loaded with food recently, it will take longer for it to attain the set temperature.
- Large amounts of hot food might be put in the refrigerator recently. >>>Do not put hot food into the refrigerator.

• Vibrations or noise.

- The floor is not level or stable. >>> If the refrigerator rocks when moved slowly, balance it by adjusting its feet. Also make sure that the floor is strong enough to carry the refrigerator, and level.
- The items put onto the refrigerator may cause noise. >>>Remove the items on top of the refrigerator.

There are noises coming from the refrigerator like liquid flowing, spraying, etc.

- Liquid and gas flows occur in accordance with the operating principles of your refrigerator. It is normal and not a fault.

Whistle comes from the refrigerator.

- Fans are used in order to cool the refrigerator. It is normal and not a fault.

Condensation on the inner walls of refrigerator.

- Hot and humid weather increases icing and condensation. It is normal and not a fault.
- Doors are opened frequently or left ajar for a long time. >>>Do not open the doors frequently. Close them if they are open.
- Door is ajar. >>>Close the door completely.

Humidity occurs on the outside of the refrigerator or between the doors.

- There might be humidity in the air; this is quite normal in humid weather. When the humidity is less, condensation will disappear.

Bad odour inside the refrigerator.

- No regular cleaning is performed. >>>Clean the inside of the refrigerator regularly with a sponge, lukewarm water or carbonate dissolved in water.
- Some containers or package materials may cause the smell. >>>Use a different container or different brand packaging material.
- Food is put into the refrigerator in uncovered containers. >>>Keep the food in closed containers. Microorganisms spreading out from uncovered containers can cause unpleasant odours.
- Remove the foods that have expired best before dates and spoiled from the refrigerator.

The door is not closing.

- Food packages are preventing the door from closing. >>>Replace the packages that are obstructing the door.
- The refrigerator is not completely even on the floor. >>>Adjust the feet to balance the refrigerator.
- The floor is not level or strong. >>>Make sure that the floor is level and capable to carry the refrigerator.

Crispers are stuck.

- The food is touching the ceiling of the drawer. >>>Rearrange food in the drawer.

請先閱讀本使用者手冊！

尊敬的客戶：

我們希望以現代化工廠生產，並以最細緻的品質控管流程檢查的本產品能為您提供有效的服務。

因此，在使用本產品之前，請仔細閱讀本使用者手冊，並儲存好以備未來參考。如果您將本產品轉交給他人，請一併轉交使用者手冊。

本使用者手冊將幫助您以快速又安全地方式使用本產品。

- 在安裝以及操作本產品之前，請閱讀本手冊。
- 請您確實閱讀安全說明。
- 請將本手冊放置在容易拿到的地方，您日後可能會需要它。
- 請閱讀本產品附帶的其他文件。

請注意，本使用者手冊同樣適用於數種其他型號。各型號之間的差異將會在本手冊中指出。

符號解釋

在本使用者手冊中使用了以下符號：

i 重要的資訊或有用的提示。

⚠ 對生命以及財產可能會產生危險的警告。

⚡ 對電壓的警告。

1 您的冰箱	3	5 使用冰箱	15
2 重要安全性警告	4	恆溫器設置按鈕	15
預定用途	4	冷藏	15
一般安全	4	冷凍	15
有飲水機	7	除霜	16
的產品;	7	關閉產品	17
兒童安全	8	6 維護及清潔	18
遵守 WEEE 指令和廢棄產品處置: ...	8	塑膠表面的保護	18
包裝資訊	8	7 故障排除	19
HC 警告	8		
為節約能源需要做的事.....	8		
3 安裝	10		
在挪動冰箱時需要注意的事項	10		
電氣連接	10		
包裝處置	10		
老舊冰箱的處置	10		
放置及安裝	10		
更換照明燈	12		
變更開門方向	13		
4 準備	14		

1 您的冰箱

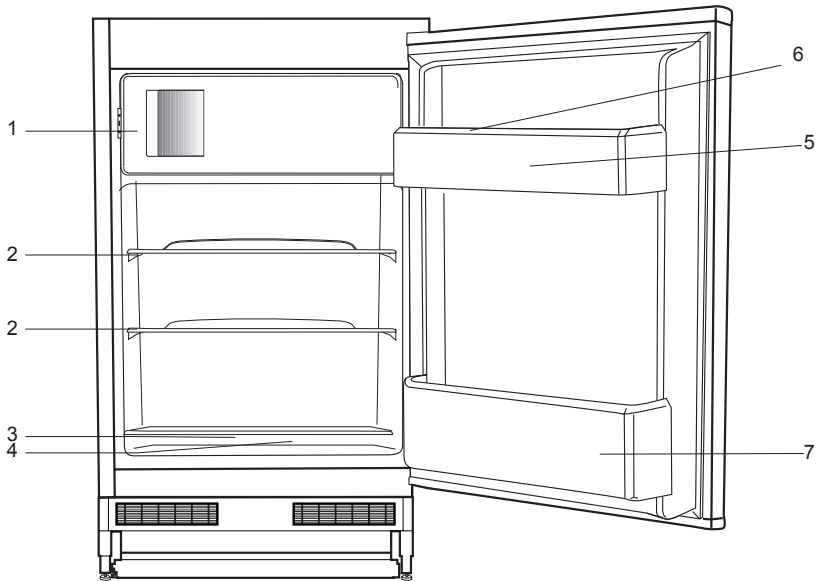

1. 用於新鮮食物保鮮、冷凍食品、快速冷卻飲料、製作冰塊。
2. 烘焙、冷凍熟食、乳製品。
3. 肉類、香腸、冷盤、罐頭。
4. 水果、蔬菜、沙拉。
5. 管子、小瓶和罐頭。
6. 蛋盒。
7. 飲料、大瓶。

i 本說明手冊中的圖片為示意圖，可能與您的產品不完全相同。如物件不在您購買的產品之內，即代表適用於其他型號。

2 重要安全性警告

請審閱下列資訊。如不閱讀此資訊可能會導致人身傷害或財產損失。否則，所有保固和可靠性承諾將失效。

在產品購買日期後的 10 年內提供原廠備件。

預定用途

⚠	<p>警告： 保持設備外殼或內置結構中的通風口暢通。</p>
⚠	<p>警告： 請勿使用製造商建議以外的機械設備或其他方法加快除霜過程。</p>
⚠	<p>警告： 請勿損壞製冷劑回路。</p>



警告：

請勿在食品儲存室內使用製造商建議種類以外的電器。

本設備旨在用於家庭和類似的應用中，例如

- 商店、辦公室以及其他工作環境的員工廚房區域；
- 農場及飯店、汽車旅館和其他住宿類型環境的客戶；
- 住宿加早餐飯店環境；
- 餐飲和類似的非零售應用。

一般安全

- 若要處理報廢產品，我們建議您與授權服務部門進行諮詢，瞭解所需的信息和授權機構。
- 有關冰箱的所有問題和困難，請與授權服務部

門進行諮詢。在沒有通知授權服務部門的情況下，請勿擅自干預或讓任何人干預冰箱。

- 對於冷凍室的產品；把甜筒冰淇淋以及冰塊從冷凍室中取出後，請勿立即吃它們！（這可能會導致您的口中產生凍傷。）
 - 對於冷凍室的產品；請勿將瓶裝或罐裝液體飲料放入冷凍室內。否則，它們可能會產生爆炸。
 - 請勿直接觸碰冷凍食品；它們可能會黏在您的手上。
 - 在清潔或除霜前，請拔掉冰箱的插頭。
 - 蒸汽和汽化清潔材料不應當用於冰箱的清潔和除霜過程。在此類情況下，蒸汽可能與電氣零件接觸，導致短路或觸電。
 - 請勿將冰箱的某個部分（如門）當作支撐方式或踏板。
 - 請勿在冰箱內使用電氣裝置。
 - 請勿使用鑽孔或切割工具損壞製冷劑循環的部件。當蒸發器、管線
- 延伸或表面塗層有隙縫時，製冷劑可能會從氣體通道噴出，造成皮膚不適以及眼睛損傷。
 - 不要用任何物品覆蓋或堵塞冰箱的通風孔。
 - 電氣裝置只能由經過授權的人員進行維修。由不稱職的人員進行的維修會對使用者產生風險。
 - 如果發生任何故障或在維護或維修工作期間，請關閉相應的保險絲或拔下冰箱的電源，斷開冰箱的電源連接。
 - 請勿以拉扯電線的方式拔下插頭。
 - 確保高度酒精飲料以扭緊蓋子以及直立放置的方式安全儲存。
 - 請勿將含有易燃和易爆物質的噴霧罐存放在冰箱中。
 - 請勿使用製造商建議以外的機械設備或其他方法加快除霜過程。
 - 本產品不適合由有生理、知覺或精神障礙或未經學習或沒有經驗的人員（包含兒童）使用，除非有一位為他們的安全負責或指導他們相應地使用該產品的人

員陪同。

- 請勿使用損壞的冰箱。如您有任何問題，請與服務代表諮詢。
- 只有您家中的接地系統符合標準才能保證冰箱的電氣安全。
- 將產品暴露在雨、雪、陽光和風中對於電氣安全而言是危險的。
- 當電源線損壞時，請與授權的服務部門聯絡，以避免危險。
- 在安裝過程中請勿將冰箱的插頭插入牆壁插座。否則，可能會導致死亡或嚴重傷害危險。
- 本冰箱僅用於儲存食品。不得用作任何其他用途。
- 技術規格標籤位於冰箱內的左側壁上。
- 請勿將冰箱連接到節電系統；它們可能損壞冰箱。
- 如果冰箱上有藍光，請勿用光學工具直視藍光。
- 對於手動控制的冰箱，停電後請至少等待5分鐘再啟動冰箱。
- 將本產品轉交給他人時，應將本操作手冊交

給新持有人。

- 在運輸冰箱時，請避免破壞電源線。將電線彎曲可能會導致火災。請勿在電源線上放置重物。將本產品插入插座時，請勿用濕手觸摸插頭

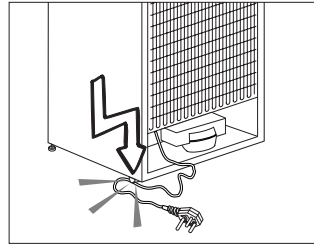

- 當牆壁的插座鬆脫時，請勿將冰箱插頭插入。
- 為安全起見，請勿將水噴灑在產品的內部或外部。
- 請勿在冰箱附近噴灑含有丙烷氣體等易燃氣體的物質，以免發生火災和爆炸。
- 請勿將盛有水的容器放在冰箱的頂部；溢出可能會導致觸電或火災。
- 請勿將冰箱裝入過多的食物。如果裝載過多，在您打開冰箱門時，食物可能會掉下來，對及冰箱產生傷害。
- 請勿在冰箱頂部放置物

品；否則，在打開或關閉冰箱門時，這些物體可能會掉落。

- 由於疫苗、熱敏藥物以及科學物品等需要精準的溫度，請勿將它們儲存在冰箱中。
- 如果冰箱將在很長一段時間內不使用，請拔掉插頭。一項可能問題是電線可能會引發火災。
- 如冰箱的可調整支腳沒有妥善地放置在地上，冰箱可能會滑動。妥善地將可調整支腳固定在地上可以避免冰箱滑動。
- 在搬移冰箱時，請勿握住冰箱門把手挪動。否則，把手可能會崩斷。
- 必須將本產品放置在另一台冰箱或冰櫃旁時，兩者之間應至少相距 8 公分。否則，鄰近的側壁可能會受潮。
- 當位於本產品的頂部或後部有電子板的儲存室（電子板蓋）(1) 開啟時，請勿使用產品。

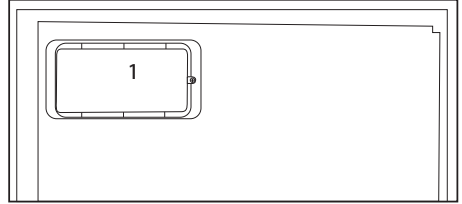
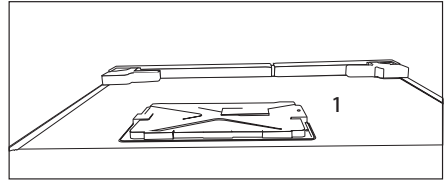

有飲水機
的產品；

- 冷水進口的最大壓力應為 90 psi (6.2 巴)。如果水壓超過 80 psi (5.5 巴)，請在主系統中使用限壓閥。如果您不知道如何檢查您的水壓，請尋求專業水管工的協助。
- 如果您的安裝中存在水錘效應風險，請在安裝時使用防水錘設備。如您不確定在安裝中是否存在水錘效應，請向專業的水管工諮詢。
- 請勿在熱水進口處安裝。為避免水管凍結，請採取預防措施。水溫的操作溫度範圍應為最

低 33° F (0.6° C), 最高 100° F (38° C)。

- 請只使用飲用水。

兒童安全

- 如門上有鎖，請將鑰匙放在孩童拿不到的地方。
- 必須監督兒童以防止他們將本產品用於玩耍。

遵守 WEEE 指令和廢棄產品處置：

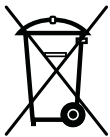

本產品與歐盟 WEEE 指令 (2012/19/EU) 相符。本產品帶有報廢電子電氣設備 (WEEE) 的分類符號。

本產品採用高品質的零件和材質製造，可重複使用，適合回收利用。因此，在使用壽命結束時，不要將產品與一般的家庭廢棄物一起處理。將其帶到電氣和電子設備回收點。請諮詢當地主管機關，瞭解最近的回收點。通過回收舊產品幫助保護環境和自然資源。為了孩童的安全起見，請切斷電源線，並將門的鎖定機制破壞（如有），使產品在丟棄之前就無法運作。

包裝資訊

產品的包裝材料是由符合國家環境法規的可回收材料製造的。不要將包裝材料與家庭或其他廢棄物一起處理。將它們帶到當地主管機關指定的包裝材料回收點。

請記得...

任何回收物質對於自然和國家資產財富都是不可或缺的。

如果您想對包裝材料的重新評估做出

貢獻，您可以諮詢環境保護組織或當地政府機構。

HC 警告

如果產品的冷卻系統包含 R600a：

此氣體易燃。因此，在使用及運送時請注意不要損壞冷卻系統及管線。如發生損壞，請將產品遠離潛在的火源，這些火源可能導致產品引燃，並請維持本設備所在房間的通風性。

如果產品的冷卻系統包含 R134a，請忽略本警告。

產品中使用的氣體類型請參見冰箱內部左側壁上的類型標籤。

請勿將本產品以投入火中的方式報廢。

為節約能源需要做的事

- 不要將冰箱的門打開很長時間。
- 不要將熱的食物或飲料放在冰箱裡。
- 不要過度裝載冰箱，以免使其內部的空氣循環阻塞。
- 請勿將冰箱安裝在陽光直射或靠近發熱器具（如烤箱、洗碗機或散熱器）的地方。將冰箱與發熱源的距離至少維持在 30 公分，距離電爐至少 5 公分。
- 請注意將食物收納在密封的容器中。

- 對於冷凍室的產品；取出冷凍室的架子或抽屜時，可以將大量的食物存儲在冰箱中。注明的冰箱能源消耗值是透過拆除冷凍架或抽屜，在最大裝載的情況下計算的。根據冷凍食物的形狀和尺寸使用冷凍架或抽屜不會有任何危害。
- 在冷藏室中將冷凍食品解凍可以節能，並維持食品品質。

3 安裝

⚠ 如未遵照本使用者手冊說明的訊息，製造商將不承擔任何責任。

在挪動冰箱時需要注意的事項

1. 應將冰箱的電源拔除。在運輸冰箱之前，應該其清空並清潔。

2. 在重新包裝之前，冰箱內的食品架、配件、保鮮儲藏格等應該用膠帶固定，防止碰撞。包裝應使用厚膠帶或牢固繩索捆綁，並嚴格遵守包裝上的運輸規則。

3. 原始包裝和泡沫材料應儲存以備將來運輸或移動之需。

在啟動冰箱之前，
在使用冰箱之前，請先檢查下列事項：

1. 如下圖所示，安裝 2 個塑膠卡榫。塑膠卡榫的用意是在於保持距離，確保冰箱和牆壁之間的空氣流通。（圖片是為示意圖，與你的產品不盡相同。）

2. 按照「維護及清潔」部分的建議清潔冰箱內部。

3. 將冰箱的插頭插入牆上插座。當冰箱門打開時，冰箱內部的燈將會亮起。

4. 當壓縮機開始運作時，將會聽到聲音。即使壓縮機沒有在運行，被密封在製冷系統中的液體和氣體也可能產生噪音，這是非常正常的。

5. 冰箱的前緣可能會有溫暖感。這屬正常現象。這些區域專門設計保持溫暖，避免冷凝。

電氣連接

將產品連接到由具有適當容量的保險絲保護的接地插座。

重要訊息：

連接方式必須符合國家規定。

- 電源插頭在安裝之後要能方便觸及。
- 只有您家中的接地系統符合標準才能保證冰箱的電氣安全。
- 位於產品內部左側標籤上的電壓應等於您的網絡電壓。
- 請勿在連接中使用延長線或多插頭。

⚠ 受損的電源線必須由合格的電工更換。

⚠ 在產品修復前請勿使用！這可能有觸電的風險！

包裝處置

包裝材料對於兒童而言可能是危險的。將包裝材料放在兒童接觸不到的地方，或根據當地主管機關規定的廢棄說明對其進行分類處理。請勿與一般家庭廢棄物一同丟棄，請丟棄在當地主關機關指定的包裝回收站。

冰箱的包裝由可回收的材料製成。

老舊冰箱的處置

用不傷害環境的方法處置老舊的冰箱。

- 您可向當地授權經銷商或當地市政府的廢棄物收集中心諮詢有關處置冰箱的事宜。

在處置冰箱之前，請切斷電源插頭，如果門上有任何鎖扣，請使其不能操作，以保護兒童免受任何危險。

放置及安裝

⚠ 如果要安裝冰箱的房間的入口門的寬度不夠讓冰箱通過，請致電授權服務部門人員，讓他們拆下冰箱的

門，轉為側面通過門。

1. 請在能方便使用的地方安裝您的冰箱。

2. 使冰箱遠離熱源、潮濕處和陽光直射。

3. 為了實現高效運作，冰箱周圍必須有適當的空氣通風。如果冰箱要放置在牆壁的凹槽中，則與天花板的距離必須至少為 5 公分，以及與牆壁之間的距離至少為 5 公分。請勿將產品放置在地毯等材料上。

4. 將冰箱放在平坦的地面上，防止滑動。

更換照明燈

如要更改用於冰箱照明的燈泡/LED，請致電當地授權服務部門。

本電器使用的電燈不適用於家庭室內照明。該燈的預期用途是幫助使用者以安全和舒適的方式將食品放置在冰箱/冰櫃中。該設備使用的燈必須能忍受極端的物理條件，例如低於 -20°C 的溫度。

(僅櫃式和立式冰櫃)

變更開門方向

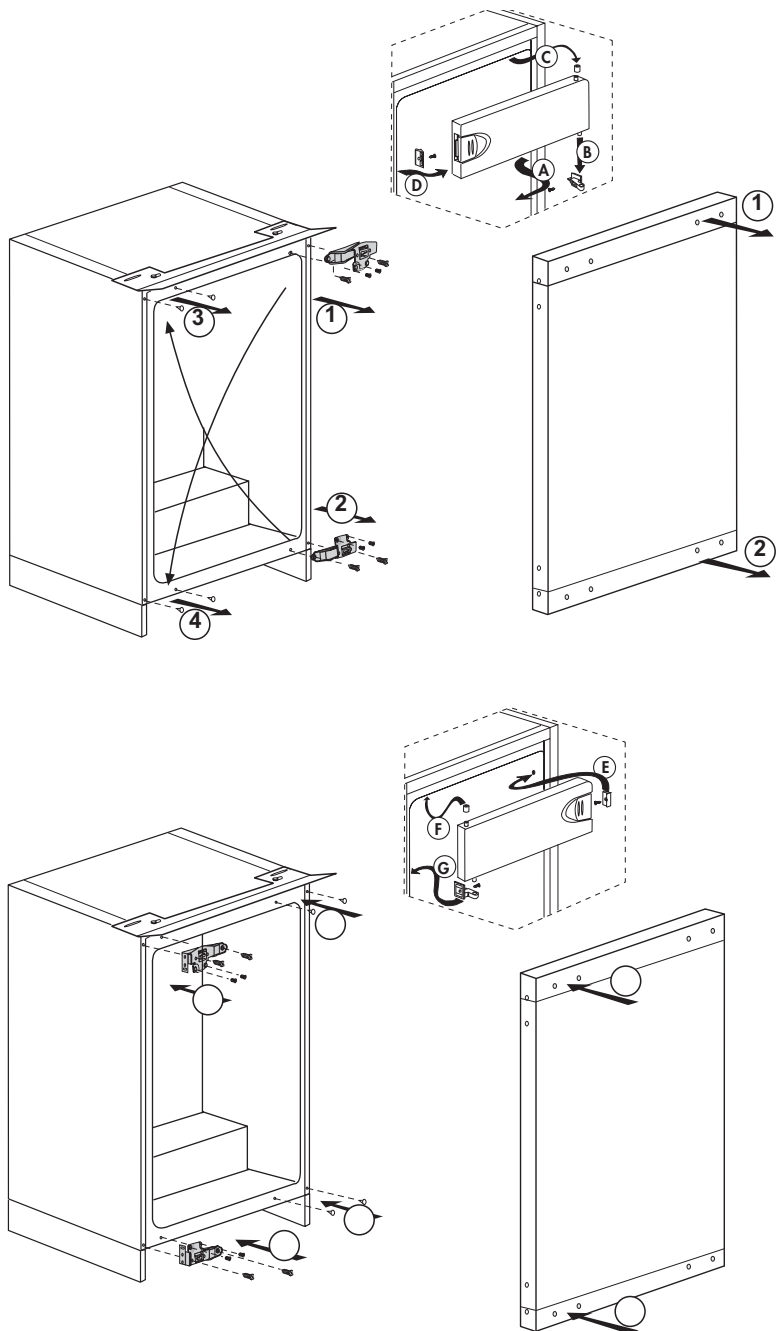

4 準備

- 冰箱應安裝在距離爐灶、烤箱、中央暖氣和爐具等熱源至少 30 公分處，距離電爐至少 5 公分，且不應放置在陽光直射處。
- 安裝冰箱的房間環境溫度至少應為 5° C。以其效率而言，不建議在更低溫的條件下運行冰箱。
- 請確保您的冰箱內部徹底清潔。
- 如果兩個冰箱要並排安裝，則它們的間距應至少為 2 公分。
- 在第一次運行冰箱時，請在最初六小時內注意以下說明。
- 冰箱門不應經常打開。
- 必須在空的情況下運行，不含任何食品。
- 請勿拔掉冰箱的插頭。如果發生了您無法控制的電源故障，請參閱「問題的建議解決方案」部分中的警告。
- 原始包裝和泡沫材料應儲存以備將來運輸或移動之需。
- 必須使用冷藏室附帶的籃子/抽屜，來達到低能消耗以及更好的收納條件。
- 冷凍室中的食物與溫度傳感器接觸可能會增加設備的能量消耗。因此，請避免與傳感器進行各種接觸。
- 在某些型號中，儀表板會在門關閉的 5 分鐘後自動關閉。當門打開或按任何鍵時，儀表板將重新啟動。
- 由於在運行期間打開/關閉本產品的門會產生溫度變化，門/主體架和玻璃容器上出現冷凝是正常的

5 使用冰箱

恆溫器設置按鈕

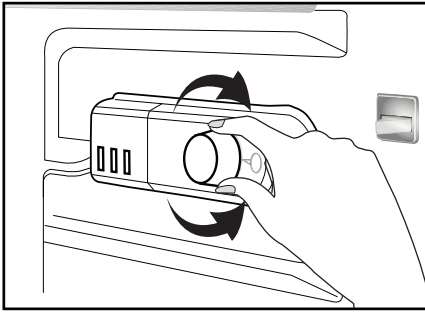

運行溫度由溫度控制進行調節。

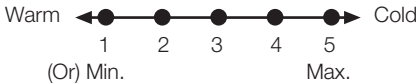

1 = 最低冷藏設定 (最溫暖的設定)

5 = 最高冷藏設定 (最冰冷的設定)

(或)

Min. = 最低冷藏設定
(最溫暖的設定)

Max. = 最高冷藏設定
(最冰冷的設定)

冰箱內的平均溫度應該在 $+5^{\circ}\text{C}$ 左右。

請根據所需的溫度選擇設定。

請注意，冷藏區域中會存在著不同的溫度。

最冰冷的區域位於蔬菜室的正上方。

內部溫度還取決於環境溫度、門打開的頻率和儲存在內部的食品數量。

頻繁地開門會導致內部溫度升高。

基於這項理由，建議在使用後儘快再度將門關閉。

冰箱的內部溫度會受以下原因改變：

- 季節溫度，
- 頻繁地打開門並長時間地將門維持在開啟的狀態中，

- 沒有等食品冷卻至室溫就把食品放進冰箱中，
- 冰箱在室內的位置 (例如：暴露在陽光直射下)。
- 您可以透過恆溫器來調整由於此類原因而變化的內部溫度。恆溫器周邊的數字代表冷藏溫度。
- 如果環境溫度高於 32°C ，請將恆溫器按鈕轉至最大位置。
- 如果環境溫度低於 25°C ，將恆溫器按鈕轉至最低位置。

冷藏

食品儲存

冷藏室應用於短期儲存新鮮的食物以及飲料。

冷凍

食品冷凍

冷凍室以 *** ** *** 符號標示。

您可以使用本設備冷凍新鮮食品以及儲存預冷凍食品。

請參考食品包裝上的建議。

儲存冷凍食品

冷凍食品室以 ****** 符號標示。

冷凍食品室適合預冷凍食品的儲存。

應遵守食品包裝上所述的儲存建議方法。

除霜

A) 冷藏室

冷藏室能執行全自動除霜。當冰箱冷卻下來時，冷藏室的內側後壁上可能會出現水滴以及 7-8 公分的結霜。此形成為冷卻系統工作的正常現象。由於後壁的自動除霜系統，霜的形成會透過一定間隔的自動除霜來解凍。使用者不需要將霜刮除或將水滴去除。

因除霜產生的水會從集水槽流出，並通過排水管流入蒸發器，並在此自行蒸發。

定期檢查排水管是否堵塞，並在必要時用棍子在孔中疏通。

靠內的冷凍室不會執行自動除霜，這是為了防止冷凍食品腐爛。

B) 冷凍室

採用特殊的除霜收集池，除霜流程簡單明瞭，沒有麻煩。

每年除霜兩次，或每當形成厚度約 7

(1/4") 公分的霜層時。

要開始除霜程序，請從插座關閉設備，拔出電源插頭。

所有食物都應以數層報紙進行包裝，存放在陰涼的地方（如冰箱或洗衣機）。

可以將含溫水的容器小心地放置在冷凍器中加速除霜。

不要使用尖銳或鋒利的物體，如刀或叉子來除霜。

請勿使用吹風機、電熱器或其他此類電器除霜。

將冷凍室底部積累的除霜水除去。除霜後，將內部徹底乾燥。

將插頭插入牆上插座，打開電源。

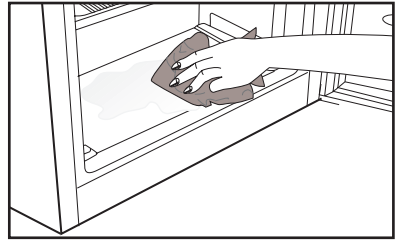

關閉產品

如果恆溫器處於「0」位置時：

- 將恆溫器的按鈕轉至「0」（零）位置時，您的產品會停止運作。除非將恆溫器按鈕轉至「1」或再次轉到任何其他位置，否則您的產品將不會啟動。

如果恆溫器處於「min」的位置：

- 將產品的插頭拔除來停止。

6 維護及清潔

⚠ 請勿使用汽油、苯或類似的材質進行清潔。

⚠ 我們建議您在清潔之前將插頭拔出。

⚠ 請勿使用任何尖銳的研磨工具、肥皂、家用清潔劑、洗衣精和打蠟拋光劑進行清潔。

① 使用溫水清潔冰箱的櫃箱並擦乾。

① 將濕布沾過一茶匙的蘇打碳酸氫鹽比上一品脫的水的溶液，擰乾後清潔內部和擦乾。

⚠ 確保沒有水滲進燈罩和其他電氣部分。

⚠ 如果您的冰箱將長時間不使用，請拔下電源線，取出所有食物，清潔並將門打開。

① 定期檢查門的封口，確保維持清潔，並且沒有食物顆粒。

⚠ 如要取下門架，請取出所有物品，然後從底座向上推門架。

⚠ 請勿使用清潔劑或含氯的水清潔產品的外表面和鍍鉻部分。氯會在這些金屬表面造成腐蝕。

⚠ 不要使用尖銳、研磨性的工具、肥皂、家用清潔劑、洗衣精、煤油、燃油、清漆等，防止塑料部分上的印刷品移除和變形。使用溫水和軟布清潔，然後擦乾。

塑膠表面的保護

① 不要將液體油或油炸食物放在冰箱中的未密封容器中，因為它們會損壞冰箱的塑膠表面。如果塑料表面有噴濺的油或油污，請用溫水清洗並立即沖洗表面的相關部分。

7 故障排除

在聯絡服務部門時請先審閱此清單。這將為您省下時間及金錢。此清單包括了由非工藝或材料使用缺陷而產生的常見投訴。此處描述的某些功能可能不存在於您的產品中。

冰箱無法運行。

- 插頭未正確插入插座。 >>>將插頭牢固插入插座。
- 冰箱連接的插座的保險絲或主保險絲已熔斷。 >>>檢查保險絲。

冷藏室（多區域、冷藏控制和移動式區域）的側壁上存在冷凝。

- 門經常打開。 >>>不要經常打開和關閉冰箱門。
- 環境非常潮濕。 >>>請勿將冰箱安裝在高濕度的地方。
- 含有液體的食品儲存在開放式的容器中。 >>>不要將含有液體內容物的食物儲存在開放式容器中。
- 冰箱的門左半開。 >>>關閉冰箱門。
- 恆溫器設置為非常冷的水平。 >>>將恆溫器設置到合適的水平。

壓縮機不運行

- 在冰箱的冷卻系統中的製冷劑壓力尚未平衡的情況下，突發的電源故障或插頭插入期間，壓縮機的保護熱能會發生爆炸。冰箱將在大約 6 分鐘後開始運行。如果冰箱在此期間結束時仍未啟動，請致電服務部門。
- 冰箱處於除霜週期。 >>>這對一台全自動除霜冰箱而言是正常情況。除霜週期會定期發生。
- 冰箱沒有插入插座。 >>>確保插頭已插入插座。
- 溫度設定不正確。 >>>選擇合適的溫度值。
- 發生停電。 >>>當電源恢復時，冰箱會恢復正常運行。

當冰箱運行時，運行的噪音會增加。

- 冰箱的運行性能可能會由於環境溫度的變化而改變。這屬正常現象且並非故障。

冰箱經常或長時間運行。

- 新產品可能會比舊型產品更為寬敞。較大的冰箱會運行較長的時間。
- 室內溫度可能高。 >>>正常情況下，產品在高溫環境下會運行較長的時間。
- 冰箱可能剛插電或可能裝有食物。 >>>當冰箱剛插電或裝有食物時，它需要更長時間才能達到設定的溫度。這屬正常現象。
- 近期內可能有大量的熱食品放在冰箱裡。 >>>不要將熱的食物放入冰箱。
- 門可能頻繁地打開或長時間地維持半遮掩的狀態。 >>>進入冰箱的暖空氣導致冰箱運行較長時間。請勿頻繁地打開門。
- 冷凍室或冷藏室的門可能維持半遮掩狀態。 >>>檢查門是否完全關閉。
- 冰箱被調節到非常低的溫度。 >>>將冰箱溫度調節至更高的溫度，等待溫度達到。
- 冰箱或冰櫃門的封口可能被弄髒、磨損、損壞或未正確就位。 >>>清潔或更換封口。損壞/破裂的封口會導致冰箱要運行更長的時間，才能保持當前溫度。

冷凍室溫度非常低，而冰箱溫度足夠。

- 將冷凍室溫度調節到非常低的值。 >>>將冷凍室溫度調節至更高的溫度進行檢查。

冷藏室溫度非常低，而冷凍室溫度是足夠的。

- 冰箱溫度被調節到非常低的值。 >>>將冰箱溫度調節至更高的溫度進行檢查。

儲存在冷藏室中的食物被冷凍了。

- 冰箱溫度被調節到非常高的值。 >>>將冰箱溫度調節到較低的值，然後進行檢查。

冷藏室或冷凍室的溫度非常高。

- 冷藏室溫度被調節到非常高的值。 >>>冷藏室溫度的設定對冷凍室的溫度有影響。更改冷藏室或冷凍室的溫度，等待相關的儲存室達到足夠的溫度。
- 門經常打開或長時間維持在半掩狀態。 >>>不要經常打開門。
- 門是半掩狀態。 >>>將門完全關閉。
- 冰箱最近剛插電或裝滿食物。 >>>這屬正常現象。當冰箱最近剛插電或裝有食物時，它需要更長的時間才能達到設定的溫度。
- 近期內可能有大量的熱食品放在冰箱裡。 >>>不要將熱的食物放入冰箱。
- 震動或噪音。

- 地板不平或不穩。 >>>如果冰箱在慢慢移動時晃動，透過調整它的支腳來平衡它。同時，確保地板足夠堅固來承載冰箱，並且是平的。
- 放在冰箱上的物品可能會產生噪音。 >>>取出冰箱頂部的物品。

有來自冰箱的噪音，如液體流動、噴灑聲等。

- 液體和氣體流動根據冰箱的運作原理發生。這屬正常現象且並非故障。

冰箱發出口哨聲。

- 冰箱使用風扇來進行冷卻。這屬正常現象且並非故障。

冰箱內壁結露。

- 炎熱和潮濕的天氣會增加結冰和冷凝。這屬正常現象且並非故障。
- 門經常打開或長時間維持在半掩狀態。 >>>不要經常打開門。如果它們是開啟的，關閉它們。
- 門是半掩狀態。 >>>將門完全關閉。

冰箱的外部或門之間很潮溼。

- 空氣中可能含有濕氣；這在潮濕的天氣是相當正常的。當濕度較小時，冷凝將消失。

冰箱內有怪味。

- 沒有執行定期清潔。 >>>定期用海綿、溫水或溶於水的碳酸鹽清潔冰箱內部。
- 有些容器或包裝材料可能會產生氣味。 >>>使用其他容器或其他品牌的包裝材料。
- 食物放在冰箱裡未密閉的容器。 >>>將食物儲存在密閉容器中。未密封的容器中生長的微生物可能導致不愉快的氣味。
- 移除冰箱中已過期的食物以及在冰箱中腐壞的食物。

門沒有關上。

- 食品的包裝防止門關閉。 >>>更換擋住門的包裝。
- 冰箱在地板沒有完全平放。 >>>調節支腳以平衡冰箱。
- 地板不平或不夠牢固。 >>>確保地板平整，能夠承載冰箱。

保鮮儲藏格卡住。

- 食物碰觸到抽屜頂部。 >>>重新排列抽屜裡的食物。

請記錄下列產品資料

型號 Model No.:

機身編號 Serial No.:

經銷商名稱 Dealer:

購買日期 Date of Purchase:

單據編號 Invoice No.:

本產品不斷改進中，如功能有所更改，恕不另行通知
如有疑問，請與客戶服務中心聯絡。不便之處，敬請原諒。

The product specifications may be changed without prior notice.
Please contact customer service for details if necessary.

說明書內容以英文版本為準

If there is any inconsistency or ambiguity
between the English version and the Chinese version,
the English version shall prevail.



保養登記
Warranty Registration

於網上登記新產品保養 Register your product online
www.dchtoolbox.com



客戶服務中心 DCH ToolBox Customer Service Centre

香港九龍灣啟祥道20號大昌行集團大廈4樓

4/F, DCH Building, 20 Kai Cheung Road, Kowloon Bay, Hong Kong

客戶服務熱線 Customer Service Hotline: (852) 8210 8210

電郵地址 E-mail: 8210service@gilman-group.com

網址 Website: www.gilman-group.com