

請記錄下列產品資料

- 型號 \_\_\_\_\_
- 機身編號 \_\_\_\_\_
- 經銷商名稱 \_\_\_\_\_
- 購買日期 \_\_\_\_\_

本產品不斷改進中，如功能有所更改，恕不另行通知，如有疑問，請與客戶服務中心聯絡，不便之處，敬請原諒。

說明書內容以英文版本為準

**ToolBox Customer Service Centre 客戶服務中心：**

4/F, DCH Building, 20 Kai Cheung Road, Kowloon Bay, Hong Kong  
香港九龍灣啟祥道20號大昌行集團大廈4樓

Customer Service Hotline 客戶服務熱線：(852) 8210 8210  
Service E-mail 電郵地址：8210service@gilman-group.com  
Please register now at 請即上網登記：www.toolbox.hk  
Website 網址：www.gilman-group.com



Proudly Serviced by:



**太平家庭電器**

**gemini**  
ITALY

**2 in 1 INDUCTION & INFRA-RED  
CERAMIC COOKER**

2合1雙頭電磁  
及電陶煮食爐

MODEL NO. 型號: GVI2800

Power: 2800W

A GILMAN GROUP BRAND

Thank you for purchasing our product. Please read this instruction manual carefully before using and keep it cautiously for your further reference. If you found some problems, please contact our after sales service center.

<b>Caution</b>	<b>3</b>
<b>Installation Instruction</b>	<b>4</b>
<b>Usable and Non-usable Utensils</b>	<b>6</b>
<b>Operation</b>	<b>7</b>
<b>Cleaning &amp; Maintenance</b>	<b>8</b>
<b>Product Specification</b>	<b>9</b>
<b>Care &amp; Maintenance</b>	<b>10</b>

## ■ Caution

1. This appliance is for indoor use only.
2. This appliance is suitable for 220V voltage.
3. Please use 13A or above specialized power socket individually. It is prohibited to share power jack with other appliances.
4. Please check the connection between the power socket and plug to make sure they are well connected. Please do not use extension cord.
5. It is prohibited to draw out or plug in the power cord with wet hand to prevent electric shock.
6. It is prohibited to draw out the power socket by pulling the cable. When the power cord is damaged, please stop using it and contact our after-sales service center for assistance.
7. Please unplug the power cord from the socket after the panel is completely cooled down.
8. Please put the appliance at a place far from Children's reach. Children less than 8 years of age shall be kept away unless continuously supervised by adult.
9. Do not use the appliance near flame or wet places.
10. Please put the appliance at the even place and do not move it during usage.
11. Please do not disassemble or restructure the appliance arbitrarily. In case of failure, user shall contact our after-sales service center.
12. Our company bears no responsibility for the failures caused by arbitrarily disassembling or restructuring the appliance.
13. Do not heat up unopened cans on the appliance, it may cause explosion.
14. It is prohibited to heat the empty pot as it would cause the damage for the pot and the appliance. Our company bears no responsibility for the failures caused by heating empty pot.
15. Metallic objects such as knives, forks, spoons and lids should not be placed on the heating panel since they can get hot and cause scalding.
16. Please make sure there is enough space around the appliance when using. Please keep the air inlet and air vent clear.
17. Keep a distance of the surface of the appliance from an overhead cabinet by 760mm or more.
18. Please do not use the appliance on carpet or tablecloth or any other low-heat resistance article.
19. Please do not place inflammable material such as paper, cloth, etc, between the appliance and the pots/pans in order to prevent the risk of fire.
20. Never try to extinguish a fire with water, but switch off the appliance and then cover flame with a lid or a damp cloth.
21. Do not break the surface of the appliance, if the surface is cracked, switch off immediately and unplug the power plug.
22. If the supply cord is damaged, it must be replaced by the qualified person in order to avoid a hazard.
23. Do not place the unit near to objects which are affected by magnet, such as Credit card, IC card, watches or radio etc...
24. Generation of heat will be made on the surface of the appliance and the cookware when in used. Do not touch the surface to avoid of hazard of burning. The surface will still be very hot after usage, please wait till it is completely cooled down before unplug the plug and start cleaning.
25. The appliance is not allowed to be used by children or mentally handicapped person for avoiding danger.

## ■ Safety Protection for Induction Cooker

1. Small objects distinguish function: To avoid dangerous caused by heating small metal objects, objects with diameter  $\leq 8\text{cm}$  will not be heated. (such as knife, fork, keys, small tea cup etc). Buzzer will make alarm sound and the cooker shut down in 30 seconds.
2. Inner temperature overheat protection: When the inner temperature reached  $100(\pm 10^\circ\text{C})$  degrees, it will automatically stop.
3. Lowest voltage and over-voltage protection: If the voltage below  $100\text{V}(\pm 10\text{V})$  or over  $270\text{V}(\pm 10\text{V})$ , the unit will stop working automatically.
4. 2 hours auto shutdown function: The unit will automatically shut down if no operation within 2 hours (120 minutes).
5. Plate overheat protection: The unit will stop heating and even shut down for some cooking functions if the temperature of plate center over  $300^\circ\text{C}$ . The unit will resume heating after the temperature drop to normal. But some functions need to press the ON/OFF icon to resume.

## ■ Safety Protection for Ceramic Cooker

1. Inner temperature overheat protection: When the inner temperature reached  $108^\circ\text{C}(\pm 10^\circ\text{C})$ , it will automatically stop.
2. Lowest voltage and over-voltage protection: If the voltage below  $100\text{V}(\pm 10\text{V})$  or over  $270\text{V}(\pm 10\text{V})$ , the unit will stop working automatically.
3. 2 hours auto shutdown function: The unit will automatically shut down if no operation within 2 hours (120 minutes).
4. Over-heat protection: If the temperature of panel over 650 degrees, the ceramic zone of the unit will stop automatically.

## ■ Installation Instruction

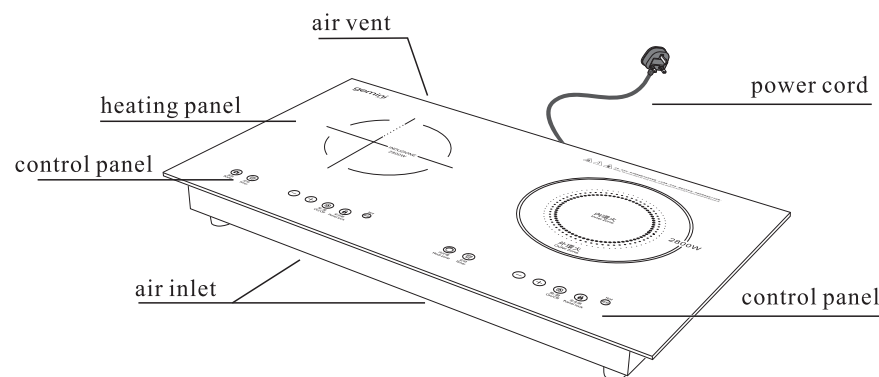

**NOTE: The unit must be installed by a qualified electrician.  
Do not attempt to install the unit by yourself.**

The tabletop groove for the unit can be made according to size of the model GVI2800. Please ensure a clear space of 55mm around the unit. The tabletop must be at least 30mm thick and made of heat resistant material to avoid deformation due to high temperature from the unit.

**Note 1.** For ventilation purposes, there should be no less than 250mm high empty space under the unit

**Note 2.** Air vent under the unit must be well circulated. Circulation between space under the unit and room atmosphere should be present.

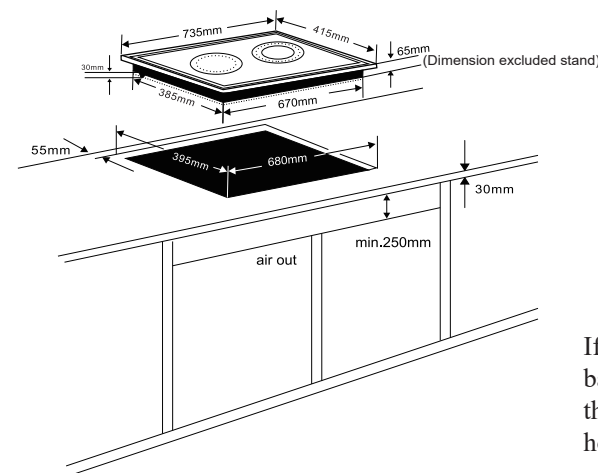

If necessary, please add the balance bar to fix the unit on the table to keep it horizontally.

The user should label the appliance prior to disposal. Do not dispose with household garbage.

Do not install the unit to the top of a not ventilated oven, refrigeration equipment, dishwasher or tumble dryer.

If a drawer is placed under the cooktop, avoid to put into this drawer flammable objects (for example: sprays) or not heat-resistant objects.

The safety gap between the cooktop and cooker hood (air hood) placed above must follow the indications of the hood manufacturer. In case of absence of instructions stated, a distance should have a minimum of 760mm.

After the installation is complete, the power cord should avoid extrusion, such as drawer.

## ■ Usable and Non-usable Utensils

- ◇ The best choice for induction cooker is strong-magnetic cookware. Please use the strong-magnetic cookware which diameter is same as the cooking zone size.

- ◇ Below material of cookware bottom is recommended:
- Cast iron;
  - Enamelled coating with steel material;
  - Stainless steel material and suitable for induction cooker;

◇ Please use magnet to check the cookware whether the bottom is strong magnetic or not.

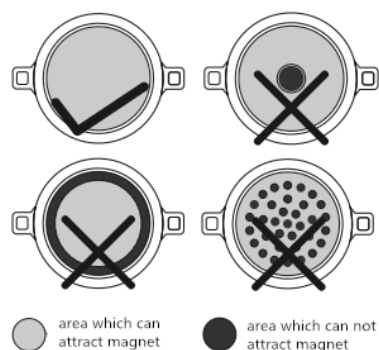

◇ The below cookwares are not recommended to be long used on induction cooker. These cookwares are suitable for induction cooker, but they will shorten the life time of induction cooker under long-term using.

1. Aluminum with ferromagnetic base
2. Material #304 stainless cookwares ( this material is with low magnetic)
3. Material #201/#202 etc non-magnetic cookwares ( this material is with low magnetic).

## ■ The normal noise from induction cooker during heating

The heating way of induction cooker--the electromagnetism heat on the cookware bottom directly. According with the structure of different cookwares, induction cooker would cause below specific noise or vibration. It's normal presentation, not defective.

1. A low hum, similar to the transformer's sound.

Such noise would happen when you cook with high-level power. It comes from the energy which is transformed from the induction cooker to the cookware. This noise would be disappeared or reduced if the power is decreased.

2. Low whistle

Such noise would happen when there is an empty cookware on the heating zone. It would disappear if there is food or water added into the cookware.

3. Fizz

Such noise would happen if the cookware has different-material layers. It comes from the vibration between the different materials. The volume of such noise caused by cookware would be different because of different food quantity or cooking method.

4. Sharp whistle

Such noise would happen if the cookware has different-material layers, especially when heating cookware with high-level power. This noise would be disappeared or reduced if the power is decreased.

5. Noise from cooling fan

Induction cooker must work under controlled temperature to make sure the electronic system run well. Then there is cooking fan set in the induction cooker, it will keep running during heating. After turning off the induction cooker, the cooling fan would keep running a few minutes if the detected temperature is higher than 60°C.

## ■ Operation

1. Plug the power plug into the socket, a "Beep" sound is heard. All of the indicator lights will be flashed for one time and then off. It means that the cooker is well connected with power.
2. Press the "On/off" key in the control area of the corresponding burner one time, the related display shows "-". It means that the cooker is under standby mode.
3. Power Setting:

### ★ Induction Zone:

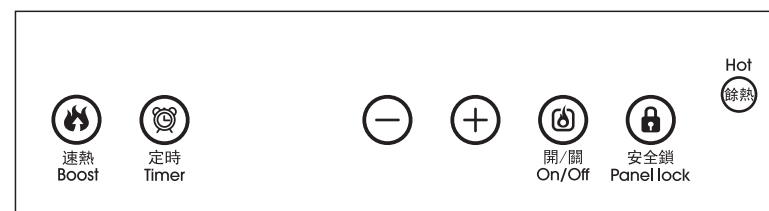

- Press "+" or "-" key when the unit is on standby mode, the LED display will show "5" it means the defaulted power level is 5. User can press "+" or "-" key to adjust the desired power level. There are 8 power levels in total from 1 to 8.
- Press "Boost" key once and the LED display will show "b", it means the unit is working at maximum power 2800W.

Please see the details in the following sheet.

	1	2	3	4	5	6	7	8	b
Power	600	800	1000	1100	1300	1400	1600	2000	2800

**NOTE:** After cooking, press "On/Off" key to switch off the burner. The hot indicator will light up if the glass plate is over 60°C to remind that the cooking plate is too hot to touch.

### ★ Ceramic Zone:

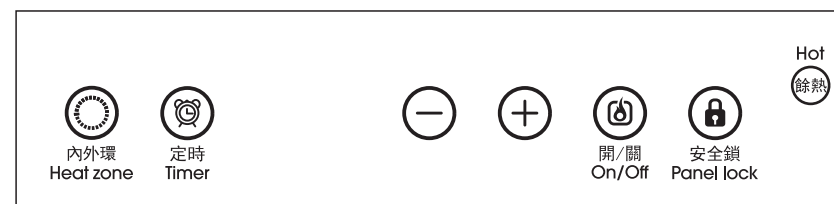

- Press “+” or “-” key when the unit is on standby mode, the hot indicator will be lighted up and the LED display will show “5” which means the power level is 5 with double rings.
- Press “Heat zone” key once, you can switch between inner ring and outer ring. The LED display will show “8”, means the unit is working at power level 8 under the inner ring mode.
- Press “Heat zone” key again, you can change to outer ring. The LED display will show “8”, means the unit is working at power level 8 under the outer ring mode.
- Press “Heat zone” key third time, you can switch back to double ring mode. The LED display will show “5”, means the unit is working at power level 5 under double rings mode.
- User can press “+” or “-” key to adjust the desired power level. There are 9 power levels in total from 1 to 9.

Please see the details in the following sheet.

	1	2	3	4	5	6	7	8	9
Single Ring	400	500	600	600	700	800	1000	1100	1400
Double Ring	700	1000	1400	1400	1400	1400	1700	2000	2800

NOTE: When the two burners work at the same time, the maximum power is 2800W.

When the power of induction zone is adjusted to b level (2800W), the infrared cooker has no power output.

When the power of infrared zone is adjusted to level 9 (2800W), the induction cooker has no actual power output.

**NOTE: After cooking, press “On/Off” key to switch off the unit. The hot indicator will keep lighting up if the glass plate is over 60°C to remind that the cooking plate is too hot to touch. The longest time that the hot indicator keep lighting up can be 20 minutes.**

#### 4. Timer Setting:

- Press the “Timer” key to activate the timer function. The LED display shows “30” indicating the default timer setting is 30 minutes.
- Press “+” key to increase the time, and press “-” key to decrease the time. User can press “+” or “-” key to set for the desired time from 00 minute to 99 minutes.
- If press and hold “+” or “-” key, the timer can increase or decrease quickly. Press the “Timer” key or wait for the time display stop flashing to confirm the timer setting. Timer will start counting down after timer setting.
- If user want to turn off the timer, set the desired time to “00” or just hold “Timer” key for 3 seconds.

#### 5. Panel Lock Setting:

At the corresponding furnace press “Panel lock” key to lock all settings at working mode or Timer mode.

Under lock status, the unit would not respond to any key press except the “On/Off” key. Press and hold this key for 3 seconds to unlock “Lock” status.

### ■ Cleaning & maintenance

- 1) Clean the unit after it is completely cooled down.
- 2) Remove the power plug prior to cleaning the unit. Do not use any caustic cleaning agents and make sure that water does not penetrate inside the unit.
- 3) Never immerse the unit, cable or the plug into water.
- 4) Wipe off the glass cooker with a damp cloth or use a mild, non-abrasive soap solution.
- 5) Do not use any oil based cleansing products in order not to damage the plastic parts or the casing/oper-

ating panel.

- 6) Do not use any flammable, acidic or alkaline materials or substances near the unit, as this may reduce the service life of the unit and pose a fire risk when the unit is turned on.
- 7) In order to keep your cooker looking new, make sure that the bottom of your cookware does not scrape the glass surface, although a scratched surface will not impair the use of the unit.
- 8) Make sure to properly clean the unit before storing it in a cool, dry place.
- 9) Cleaning and user maintenance shall not be made by children without supervision.

### ■ Product specification

Model	GVI2800
Voltage	220V~50Hz
Max. Output Power (W)	2800W
Unit Size (mm)	735(L) x 415 (W) x 65 (H) (Dimension excluded stand) 735 (L) x 415 (W) x 95 (H) (Dimension included stand)
Unit Weight (kg)	8.85
Power adjustment range (W)	Left induction 600-2,800W Right infrared 400 (single ring)-2,800W (double rings)
Glass panel dimension(mm)	735 (L) x 415 (W)
Base cross-section dimension	670 (L) x 385 (W)

### ■ Heating principle of Ceramic Cooker

Considering the max. heat-resistant temperature of ceramic glass is only 750-800°C and to avoid the ceramic glass would be broken caused by over heated, the power rate will be decreased when the temperature of heating plate reaches to approx. 710°C(±20°C) after heating approx. 1 minute, and the power rate will keep heating continuously under stable range, the constant temperature will keep at approx. 680°C(±20°C).

This heating program can make sure the ceramic glass’ using life time, and continuous heating can avoid the water temperature changing too big to delay the boiling time.

## ■ Care & Maintenance

During operations, if any error code occurred, please check the following table before calling for service. Below are common errors and the check to perform.

Failure phenomenon	Analysis	Solution
After connecting the power and pressing the “On/Off” key, the appliance has no response.	Is the plug loose or poor contact?	Use after resuming the electricity.
	Is the plug socket connected well?	Check the root causes carefully. If the problem cannot be fixed, please contact Service Centre for checking and repairing.
	Is the automatic switch fuse in the home short-circuited?	
Heating being interrupted in normal use and a “Beep” will be heard.	Incompatible cookware or no cookware is used?	Replace compatible cookware for the induction cooker.
	Is the cookware not considerably placed from the center of the heating zone?	Place the cookware at the center of the defined heating zone.
	Is the cookware being heated but continually being removed?	Place a cookware inside the heating zone.
No operation during the heating being in use.	Is the cookware empty or the temperature too high?	Please check whether the appliance is being misused.
	Is the air intake/exhaust vent clogged or dirt has accumulated?	Remove the stuff clogging the air intake/exhaust vent. Operate the appliance again after cooled down.
	Is the cooker working over 2 hours without any external instruction?	Reset cooking modes or use timer function.
Error codes occur (For ceramic zone)	E0- The fan short circuit E1- The fan open circuit E2- Sensor of PCB overheat E3- Over-voltage E4- Under-voltage E5- Thermal couple open /short circuit E6- Sensor of PCB open/short circuit E7- Thermal couple overheat	Please contact service center for checking and repairing. When E3 or E4 occurs, pls switch off the cooktop and use again after 10 minutes. If other error code occurs, pls contact service center for checking and repairing, please do not repair it by yourself.
Error codes occur (For induction zone)	E0- Internal circuit error E1- No cookware or incompatible cookware E2- Internal overheat E3- Over-voltage E4- Under-voltage E5- Top plate sensor open/short circuit E6- IGBT sensor open/short circuit E7- Top plate overheat E8- Power sharing failed	- Keep the heat vents clear - The induction cooker may overheat or damaged if bottom heat vents are blocked. - Please do not place light table cloth/sheet under the induction cooker when using. Otherwise, heat vents may be blocked by those materials. - Thick table cloth or plastic plate are suggested as replacement. - Please contact service centre for checking and repairing. When E0, E2, E5-E8 erro code occurs.

## 使用前請仔細閱讀使用說明書

感謝你使用本產品，使用前請仔細閱讀本說明書，請妥善保存，以便查閱。如發現任何問題，請直接與我們聯繫，我們將提供最好的服務。

安全注意事項 ..... 12

安裝說明 ..... 13

鍋具的選擇 ..... 15

操作方法 ..... 16

保養及清潔 ..... 17

規格參數 ..... 18

故障診斷方法 ..... 19



## ■ 安全注意事項

1. 本產品不適用於室外。
2. 本產品的適用電壓為220V。
3. 請單獨使用13A以上的專用電源插座，嚴禁與其他大功率電器同時使用。
4. 使用前請檢查插座與插頭的接觸情況，確保連接正常，切勿使用延長線。
5. 切勿在手濕仍未乾透時插拔電源插頭。
6. 切勿用拉扯電源線的方式拔出電源插頭。發現電源線破損時，請停止使用，應及時與客戶服務聯繫。
7. 烹飪完成後請待爐面冷卻後再將電源插頭拔離插座。
8. 請勿將本產品放置於兒童可觸及的地方，除非有成人監管，8歲以下孩童應遠離本產品。
9. 請勿靠近火源或潮濕的地方使用此電器。
10. 請放置在水平面上使用，使用時請勿隨意移動本產品。
11. 請勿自行拆裝或改造本機，如出現故障時，請立即與客戶服務中心聯繫。
12. 如因自行拆裝或改造本機導致事故，本公司將概不負責。
13. 請勿加熱罐頭等密封的東西，否則會導致爆炸。
14. 嚴禁在本產品上將空鍋加熱，或會造成鍋具損壞，若因此而造成此爐具損壞或發生危險，本公司概不負責。
15. 金屬物品如刀、叉、湯匙和蓋子等不可直接放在爐具面板上，或會因接觸發熱而導致使用者燙傷。
16. 使用本產品時請確保產品周圍有足夠的空間，請勿堵塞進、排氣口，以保持暢通。
17. 本產品灶面須與頂柜保持760毫米或以上的距離。
18. 請勿在地毯、桌布等易燃物上使用此爐具。
19. 請勿將易燃物（如紙張）或金屬物品放置在面板與鍋具之間，或會因此而發熱或燃燒，而導致火災。
20. 如發生火災時切勿使用水澆滅火種，應即時關閉爐具，並用鍋蓋合上或者濕布蓋住火種。
21. 本產品的面板請儘量避免撞擊，萬一撞裂時，應立即關機，並拔掉電源插頭。
22. 請勿自行更換電源線，應由符合資格的技术人員幫忙更換。
23. 請勿將信用卡、磁卡、手錶或收音機等物品置於本機附近，以免爐具受磁場影響。
24. 使用時，本產品會產生大量的熱量，請勿用手觸摸面板以免燙傷。使用後，面板仍處於高熱狀態，需待其完全冷卻之後，方可拔出插頭，進行清潔。
25. 本產品不適用於兒童或弱智人士使用，以免造成危險。

## ■ 電磁爐安全保護

1. 小物件檢測功能：為防止小金屬物加熱時發生危險，直徑小於8cm的鍋具或小物件（如刀叉、鑰匙、小茶杯等）將不會被加熱，蜂鳴器會鳴叫提示，30秒後自動關機。
2. 內部超溫保護：當產品內部溫度超過100℃（±10℃），將會自動停止運作。
3. 高低壓保護：如果電壓低於100V（±10V）或高於270V（±10V），該產品將會自動停止運作。
4. 2小時無人看管自動關機功能：如果連續2小時未進行任何操作，電磁爐將自動關機。
5. 面板過熱保護功能：如果面板中心的溫度超過300℃時，電磁爐將自動停止加熱，及部分功能將自動關機。待溫度下降至正常後，電磁爐將自動恢復加熱，但部分功能需要再按電源開關鍵重新啟動。

## ■ 電陶爐安全保護

1. 內部超溫保護：當產品內部溫度超過108℃（±10℃），將會自動停止運作。
2. 高低壓保護：如果電壓低於100V（±10V）或高於270V（±10V），該產品將會自動停止運作。
3. 2小時無人看管自動關機功能：如果連續2小時未進行任何操作，電陶爐將自動關機。
4. 過熱保護：如果面板溫度超過650℃，爐具的電陶區域將會自動停止運作。

## ■ 安裝說明

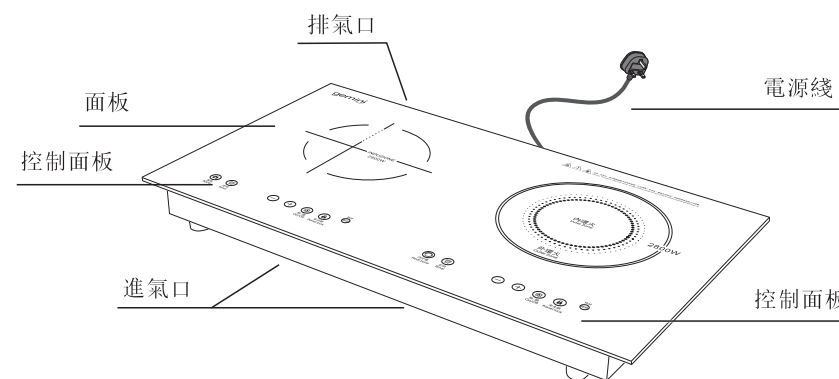

注意：本機的安裝必須由符合資格的安裝技工完成。請勿嘗試自行安裝煮食爐。

桌面上的凹槽可以根據GIV2800型號而定。請確保爐灶與牆面的淨空間為55毫米。桌面厚度最少為30毫米，桌面必須為耐熱性能強的材質，以防因高溫導致桌面變形。

注意1. 安裝時注意機身底部以下必須預留不少於250毫米高的空間排風。

注意2. 機身底部進出風口不能設在封閉的空間裏，必須保持與不同空間的空氣連接，並儘量與房間裏的空氣保持一定程度的連接。

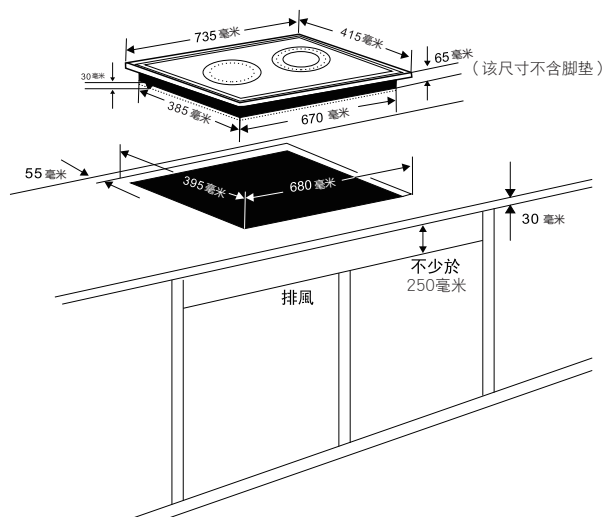

如有需要，可使用海綿條固定在桌面上，以使爐身水平放好。

用戶應在處理本產品前貼上“廢舊電器”的標籤。請勿將廢舊電器直接丟棄在家居垃圾中。

請勿將爐具安裝在不通風的焗爐、製冷設備、洗碗機和轉筒式乾燥機上。

若爐具下方裝有抽屜，避免將易燃或不耐高溫的物品（如噴劑）放置在抽屜內。

爐具與抽油煙機的間隔請遵從抽油煙機的指引。若指引中無說明，建議兩者距離至少760毫米。

安裝完成後，電源線應避免擠壓，例如抽屜。

## 鍋具的選擇

◇ 只有強磁類鍋具是唯一適用於電磁爐烹煮的鍋具。為了獲得良好的烹調效果，鍋具的強磁區域直徑應與電磁爐加熱盤的大小匹配。

◇ 適用的鍋具底部的材料可由下列材料製成：

- 鑄鐵製成的；
- 含搪瓷塗層，且以鋼製成的；
- 以不鏽鋼製成，且適用於電磁爐的；

請利用磁鐵檢查鍋具底部強磁區是否適用於加熱區。



◇ 以下是不推薦長期使用在電磁爐的鍋具。這些鍋具雖然能用在電磁爐上，但長期使用會影響電磁爐的壽命：

1. 帶有電磁復底的鋁鍋
2. #304材質的不鏽鋼鍋類（此類材質屬於弱磁性）
3. #201/#202等不帶磁性材質的鍋類（此類材質屬於弱磁性）

## 電磁爐運轉期間的正常噪音

電磁爐是透過電磁直接在鍋底產生熱能的。根據鍋具的結構，電磁可能產生如下詳述的特定噪音或振動，此皆屬正常現象，不代表有故障問題。

1. 低嗡嗡聲，類似變壓器

以大火烹煮時會產生這種噪音。此噪音來自從電磁爐轉換至鍋具的能量。此噪音會在火力減小時消失或減少。

2. 低哨聲

空鍋時會產生這種噪音。只要在鍋中加入食物或水，噪音立即消失。

3. 嘶嘶聲

發生於使用各層材質不同的鍋具時。此噪音來自於不同材質的振動。這類由鍋具造成的噪音，可能因食物份量或烹調方式而有所不同。

4. 尖哨聲

此噪音多數是由各層材質不同的鍋具所產生，尤其是以大火加熱鍋具時。只要減小火力，此哨聲就會消失或減少。

5. 來自風扇的噪音

要讓電子系統運作得宜，電磁爐必須在受控溫度下運轉。為達此目的，電磁爐設有風扇，會在加熱時運轉。在電磁爐電源關閉後，若測得的溫度高於60℃，風扇會繼續運轉幾分鐘。



## ■ 操作方法

1. 當插上插頭時，會有蜂鳴器“嗶”一聲，所有指示燈閃一下然後關上，這代表本機進入連接但未正式開啟。
2. 在對應的爐頭控制區域按下“開/關”鍵一次，顯示屏顯示“—”，即表示該爐頭進入待機模式。
3. 火力設置：

### ★ 電磁區域：

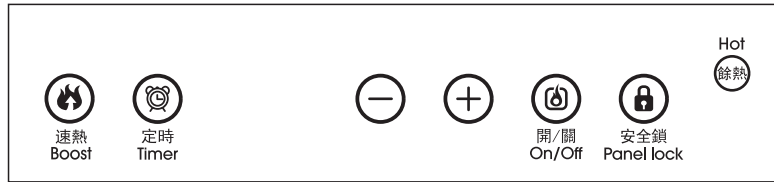

- 當本機處於待機模式時按“+”或“-”鍵，LED顯示屏顯示“5”，即電磁區域的火力單位是第5級。用戶可按“+”或“-”鍵設定所需的火力大小，共有8個級別。
- 按“速熱”鍵一次，LED顯示屏顯示“b”，即電磁區域將在最大火力2800W下運作。

各火力大小的對應如下表：

	1	2	3	4	5	6	7	8	b
火力	600	800	1000	1100	1300	1400	1600	2000	2800

注意：完成煮食後，按“開/關”鍵關機。當電磁區域的面板溫度高於60℃，熱力指示燈會亮著，以提醒用戶請勿以手觸摸面板，以免燙傷。

### ★ 電陶區域：

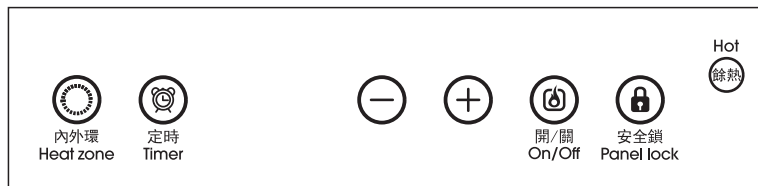

- 當本機處於待機模式時按“+”或“-”鍵，熱力指示燈亮，LED顯示屏顯示“5”，此時電陶區域在雙環加熱模式下的火力是第5級。
- 按“內外環”鍵一次來切換到內環的加熱模式。LED顯示屏顯示“8”，此時電陶區域在內環加熱模式下的火力是第8級。
- 按“內外環”鍵第二次切換到外環的加熱模式。LED顯示屏顯示“8”，此時電陶區域在外環加熱模式下的火力是第8級。
- 按“內外環”鍵第三次恢復到雙環加熱模式。LED顯示屏顯示“5”，此時電陶爐在雙環加熱模式下的火力為第5級。
- 用戶可按“+”或“-”鍵來設定所需的火力大小，共有9個火力。

各火力大小的對應如下表：

	1	2	3	4	5	6	7	8	9
單環加熱	400	500	600	600	700	800	1000	1100	1400
雙環加熱	700	1000	1400	1400	1400	1400	1700	2000	2800

請注意：當電磁和電陶區域同時運作，最大的總火力是2800W。

當電磁爐設定b火力（2800瓦）時，電陶爐無功率輸出。

當電陶爐達到最大第9火力（2800瓦）時，電磁爐無功率輸出。

注意：完成煮食後，按“開/關”鍵關機。當電陶區域的溫度高於60℃時，電陶區域的熱力指示燈長亮，並在關機后仍保持長亮狀態，以提醒用戶請勿以手觸摸面板，以免燙傷。長亮時間最長可達20分鐘。

### 4. 定時設置：

- 按“定時”鍵進入定時功能。LED顯示屏顯示“30”，即設定煮食時間為30分鐘。
- 按“+”鍵增加時間，按“-”鍵減少時間。用戶可按“+”或“-”鍵來設定所需的煮食時間，可設定的時間範圍為0-99分鐘。
- 長按“+”或“-”鍵可加快或減少時間的設定。可按“定時”鍵或等時間顯示停止閃爍來確認時間的設定。完成時間的設定後，本爐具會自動開始計時。
- 如要取消定時功能，用戶可將時間設置到“00”或長按“定時”鍵三秒。

### 5. 安全鎖設定：

在對應的爐頭控制區域按“安全鎖”鍵時即可鎖定烹調或定時模式。

在安全鎖狀態下，對應爐頭的所有按鈕的功能均無效，除了“開/關”鍵。

長按“安全鎖”鍵三秒即可解鎖。

## ■ 保養及清潔

- 1) 請在本爐具完全冷卻後才清潔。
- 2) 清潔前請關掉電源及拔下電源插頭。請勿使用任何腐蝕性的清洗劑，並且確保沒有水流進本爐具內。
- 3) 請勿用水或其他液體沖洗本爐具和電源線。
- 4) 請用濕布或中性去污粉或洗潔精擦拭面板。
- 5) 請勿使用任何油性清洗產品清潔面板，以免破壞塑料部件或面板。
- 6) 請勿將任何易燃、酸性、鹼性材料或物質放置在本爐具附近，因容易減少本爐具的使用壽命及在使用過程中容易引起火災。
- 7) 請注意使用時不要讓鍋底刮到玻璃面板，雖然表面劃痕不會影響本爐具使用。
- 8) 請保證合理清潔本爐具後才將它放置在乾爽的地方。
- 9) 在無人監管下不應讓孩童進行本爐具的清潔與維修。

■ 規格參數

型號	GVI2800
適用電壓	220V~50Hz
最大輸出功率（瓦）	2800瓦
產品尺寸（毫米）	735（長）x 415（寬）x 65（高）（該尺寸不含腳墊） 735（長）x 415（寬）x 95（高）（該尺寸含腳墊）
重量（公斤）	8.85
功率調節範圍（瓦）	左邊600-2,800W 右邊400（單環火）-2,800W（全環火）
玻璃平面尺寸（毫米）	735（長）x 415（寬）
底盤橫切面尺寸（毫米）	670（長）x 385（寬）

■ 電陶爐的工作原理

基於電陶爐面板的最高耐溫溫度僅有750~800℃，為了避免出現面板因溫度過高而出現爆裂的危險情況，本機將會在開機約1分鐘爐盤中心溫度達到約710℃（±20℃）時會進行降功率，並保持在穩定的功率範圍內進行持續加熱，恒溫溫度維持在約680℃（±20℃）。

這樣既保證了電陶爐面板的使用壽命安全，亦能持續加熱，避免水溫溫差變化過大而延長了沸騰的時間。

■ 故障診斷方法

在使用期間，如出現任何故障，送去維修前請按下表檢查。以下是常見的故障和對應的解決方法。

故障現象	分析	方法
連接電源線後，按電源開關鍵，爐具無反應。	插頭是否鬆脫或接觸不良？	檢查電源。
	插座電源有沒有連接？	仔細檢查根源，如問題不能解決，請聯絡售後服務部。
	家中的自動開關式保險絲是否發生短路？	
加熱中斷，伴有蜂鳴器“嗶”聲。	面板上是否無鍋或使用的鍋具不合適？	放置/更換合適的鍋具。
	放置的鍋具是否偏離加熱區域？	將合適的鍋具放置在加熱區域的正中。
	是否在加熱時不停移動鍋具？	請聯絡售後服務部。
運作但不加熱。	鍋具是否空著的？	請檢查。
	進、排氣口是否被堵住？	請將堵住進、排氣口的物件移走。待本機冷卻後再使用。
	是否已使用超過兩小時并無任何操作？	重啟機器或使用定時功能設定煮食時間。
故障代碼 (適用於電陶區域)	E0- 風機短路 E1- 風機開路 E2- PCB 傳感器過熱 E3- 高壓 E4- 低壓 E5- 熱電偶開路或短路 E6- PCB 傳感器開路或短路 E7- 熱電偶過熱	請聯絡售後服務部。 當出現故障代碼E3或E4時，請開機10分鐘後再使用。 如出現其他故障代碼，請聯絡售後服務部，請勿自行維修。
故障代碼 (適用於電磁區域)	E0- 內部電路故障 E1- 無鍋或鍋具不合適 E2- 產品內部溫度過高 E3- 高壓 E4- 低壓 E5- 主傳感器開路或短路 E6- IGBT 傳感器開路或短路 E7- 爐面溫度過高/主傳感器失效保護 E7- 燈板通訊失效	- 請保持機底散熱出風口暢通。 - 如機底散熱出風口被阻，可能會導致機器過熱而自動停機或損壞。 - 建議使用此產品時，儘量避免放置機身於一次性膠檯布/薄檯墊上。 - 建議用厚膠片或厚紙墊代替，以免檯布或檯墊過輕而被吸入及阻塞機底散熱出風口。 - 如出現錯誤代碼E0, E2, E5-E8, 請聯絡售後服務部。