

- For cleaning the Blender Jar: Pour a little warm soapy water into the jar, mount on the main body, cover with the lid and stopper & turn the speed selector to I for at least 30 seconds, then remove it & wash with clean water.
- Thorough cleaning: You can remove the blade unit and clean all parts separately.
- Never clean the accessories & parts in the dishwasher
- Dry all the parts and then replace them
- If any problem has been encountered during use never disassemble the Motor Unit by yourself, No user serviceable parts inside. Contact only the authorized service facility for examination and repair.
- Note: Do not lose any accessories.

SPECIFICATIONS:

PRODUCT	JUICE EXTRACTOR / BLENDER
MODEL NO.:	FD5181
CAPACITY	1.5L – BLENDER
	550ML – JUICE CUP 1.5L – PULP CONTAINER
VOLTAGE	220-240V
HERTZ	50Hz
WATTS	400W
MADE IN	CHINA

Environment friendly disposal



You can help protect the environment!
Please remember to respect the local regulations: hand in the non-working electrical equipments to an appropriate waste disposal center.



FRIGIDAIRE®

IS A REGISTERED TRADEMARK USED UNDER LICENSE
FROM FRIGIDAIRE INTERNATIONAL COMPANY, U.S.A
10200 David Taylor Drive, Charlotte, NC28262
U.S.A.

FRIGIDAIRE®

INSTRUCTION MANUAL JUICE EXTRACTOR / BLENDER



MODEL NO.: FD5181

Read this booklet thoroughly before using and save it for future reference

IMPORTANT SAFEGUARDS

When using the electrical appliances, the below basic safety precautions should always be followed.

1. Read all instructions and product labels and warnings carefully before using the appliance
2. Before using, check that the voltage power indicated on the appliance corresponds with the voltage in your home. If this is not the case, contact your dealer & do not use the Juice Extractor / Blender set.
3. For Household Use only. Do not use outdoors OR for commercial purposes.
4. **Operating time must not exceed 1 minute. After operating for 1 minute, stop it for 1 minute, then use again. After the above operation is performed for 3times then stop using for 15minutes and let the motor cool down before using it again. This will prolong the life & work efficiency of motor.**
5. Do not operate the machine other than its intended use.
6. Do not let the cord hang over edge of table or counter.
7. Always use the appliance on the stable & flat surface.
8. Do not operate any appliance with a damaged cord or plug or other components are damaged or after the appliance malfunction or has been damaged by any manner. Return the appliance to the nearest authorized service facility for examination, repair or adjustment.
9. Avoid contacting moving parts, Switch off the appliance before approaching parts which move in use.
10. Never remove or change accessories or parts from the motor unit while the appliance is running. Always unplug the appliance first.

Blender:

1. Make sure the switch is in OFF position.
2. Put the sealing ring into blade base slot, screw and fasten blender into the base (clockwise for fastening and counter clockwise for loosening), then put the fruit & close it with the lid & stopper.
3. Clockwise screw the blender on to the main body with your hand (counter clockwise for loosening). Never hold the blender while removing from the main body, as this might allow the blender to detach from the base & which will result the food OR juice to leak out from the blender to the base. Always hold the base to remove the blender. (Please see the figure)
4. Blades are very sharp. Please handle it carefully. In order to avoid the injury while cleaning never touch the blades & instead hold them from bottom & rinse it under the tap water for cleaning.
5. After operation, always unplug the appliance before lifting the blender to pour the juice & before cleaning.

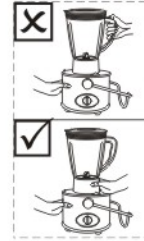

Cleaning and Maintenance:

It is recommended to clean the appliance, its part & accessories immediately after use.

Unplug the appliances before cleaning or maintaining the juice extractor and blender

- This machine shall often be used, so as to keep the motor dry and clean
- If not using for longer period of time, please store this machine at a dry and well ventilated place, so as to prevent the motor from being damped and going moldy.
- **Do not wash & immerse the main motor unit (body) in water or any other liquid for cleaning. Wipe the outer surface of motor unit with wet / damp cloth.**
- Other parts such as pushing bar, lid, stopper, blender jar, juice cup, residue cup, blade, base, juice nozzle cover etc.. could be washed directly in water

How To Use:

Juice Extractor:

1. Make sure the switch of the main machine is in O position before assembling the appliance, This will prevent the machine to start during assembling & which will avoid the unnecessary damage OR injury to the person & the property.
2. Make sure the juicing net and rotor clutched in position and there is no hard contact between juicing net cutter and transparent cover. Put the transparent cover on, than fasten the handle onto the cover slot, then switch on the machine.
3. While the appliance is ON or in working state, No-Load work OR Over-Load work is strictly prohibited.
4. Assemble according to the diagram shown above, then switch on the power & let the machine run without load for 5seconds. Then put the vegetable or fruit into the feed port of the appliance, Press evenly but hard and slowly with the Pushing bar to obtain the fresh juice of vegetable or fruit.
5. When Pressing food with the pushing bar the force shall be even or indirect, pressing force shall not be more than 1kg, do not apply sudden force, otherwise juicing effect will be reduced.
6. While making juice, make sure the residue in Middle Ring & the residue cup are not too full with juice. If too full, please cut off power supply; clean it up & then use again.
7. While using, do not open the cover. & In case the power supply is ON Make sure to not put hand or any ware item such as spoon, spatula into the mixing cup or feed port, to avoid the harmful accident OR the damage to the machine.

11. Blades are sharp, so handle carefully.
12. The use of attachment & accessories & parts, not recommended or sold by manufacturer may cause fire, electric shock or injury.
13. The appliance cannot be used for blending hard and dry substance otherwise the blade could be blunted. For Optimal results and to prevent damage to the appliance, follow the instructions with regard to the maximum and minimum processing quantities.
14. Be sure to turn switch to O position after each use. Make sure the motor stops completely and the power supply cord plug is removed from outlet, before disassembling.
15. Do not leave the appliance switched ON unattended. Close supervision is necessary when any appliance is used by or near children.
16. Use by children not intended but foreseeable, But only allowed with supervision.
17. This appliance is not intended for use by persons (including children) with reduced physical, sensory or mental capabilities, or lack of experience and knowledge, unless they have been given a supervision or instruction concerning use of the appliances by a person responsible for their safety.
18. Children should be supervised to ensure that they do not play with the appliance.
19. Do not immerse the Motor unit, plug or electrical cord into water or other liquids. Never use any wet stuffs for cleaning the electrical components.
20. Do not place the appliance near the hot gas or electric burner or other high temperature sources.

**SAVE THESE INSTRUCTIONS CAREFULLY
HOUSEHOLD USE ONLY**

Know Your Juice Extractor / Blender

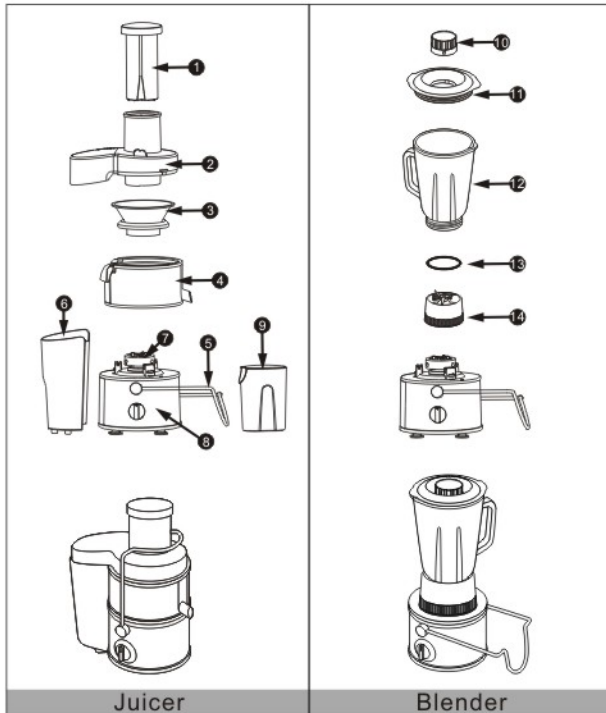

1. Pushing bar
2. Transparent cover
3. Juicing net
4. Middle ring
5. Handle
6. Residue barrel
7. Rotor

8. Main machine
9. Juice jug
10. Stopper
11. Lid
12. Blender jar
13. Sealing ring
14. Blade base

Attention Before Use:

1. This machine is set with safety unit, when the handle does not fasten the cover or the base is not fastened the motor will not work – which is to ensure the safety of the user.
2. For the first time use: As the motor works in running-in phase, there might be some peculiar smell and spark, this is normal and it will not occur after several times use
3. When assembling or disassembling the juicer, press the upper of feed port of the cover with your hand then force the handle to slide in or out of cover slot.
4. When disassembling juicing net, first remove the cover and residue barrel, then turn the middle ring up to 30 degrees by holding juicing nozzle with your hand and pull up, the juicing net will automatically leave the rotor.
5. Thoroughly clean all the parts & accessory, Except the main body before first use.
6. When assembling please carefully read & go through the diagram shown in "Know your Juice Extractor / Blender"

Operating Instructions:

This appliance is designed with 3 button switches of O, I & II. O is for stop, I is for Low speed & II is for High Speed. For juicing we recommend you to start with I (low speed) & gradually turn it to II (high speed) after few seconds.

After operating for 1 minute, stop it for 1 minute. After the 1 minute start & 1 minute stop operation is performed for 3 times, stop using the machine for 15 minutes, to let it cool down completely. This will prolong the life of machine & it will serve you more efficiently.