

CELLINI Italy

IONIC MULTI-FUNCTIONAL TOWER FAN

多功能負離子直立扇

Model: CTF38

型號: CTF38

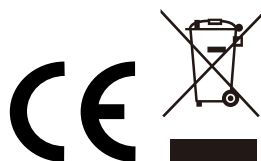

Before using your product for the first time, please read this instruction manual.

請於使用前細閱本說明書並加以保存

SAFETY INSTRUCTION

Thank you for purchasing this fan. This product has passed through extensive quality assurance process. Every care has been taken to ensure that it reaches you in perfect condition.

Attention! When using electric tools, basic safety precautions should be followed to reduce the risk of fire, electric shock and personal injury, including the following,
Read all these instructions before operating this product and keep these instructions for easy reference.

1. Check the voltage indicated on the rating plate. This fan is designed for a 220-240V~50/60Hz electric supply.
2. Do not use electrical extension cord with this fan.
3. Do not introduce your fingers through the front housing. Do not let children put any objects into the front housing.
4. Do not let hair, curtains, tablecloth, clothes or other objects next to the air outlet of the fan. They could be sucked into the fan, causing damage or injuries.
5. Do not use the fan having a cord or a plug damage, operation failure the fan is fallen or have been damage by any method.
6. Periodically check the electric cable of this fan. If the electric cable is damaged, it must be replaced by the After-sales Service Center or by a similar qualified person in order to avoid a danger.
7. Do not use this fan outdoor.
8. Do not use this fan in a damp area such as bathroom.
9. Do not use this fan on a window.
10. Do not use this fan with any semi-conductors speed control.
11. The fan should not be operated without a base nor used laying on its side.
12. Do not cover the electrical cord by any objects. Do not overlay the cord with little covers or such element. Place the cord in an area where there are not any risk to stumble over it.
13. The fan must be unplugged when not in-use. To unplug the fan, all the switches must be on the position "OFF", and then the plug could be disconnected.
14. Do not operate the fan in an area where gasoline painting or such flammable liquids is used or stocked.
15. Use this fan only as it is describe in this manual.
16. Do not try to disassemble this fan and fix it by user, If you need maintenance, please send back the fan to our After-sales Service Center.
17. All componets of this fan must not be replaced by the user.
18. If the supply cord is damaged, it must be replaced by the After-sales Service Center or a similarly qualified person in order to avoid a hazard.
19. The safety standard of this fan is without earth connection.
20. Keep this fan out of reach from Children or infirm persons and do not let them use the fan without supervision.

WARNING:

1. This appliance can be used by children aged from 8 years and above and persons with reduced physical, sensory or mental capabilities or lack of experience and knowledge if they have been given supervision or instruction concerning use of the appliance in a safe way and understand the hazards involved.
2. Children shall not play with the appliance. Cleaning and user maintenance shall not be made by children without supervised.

NOTE:

There are no serviceable parts in this unit. Do not attempt to disassemble.

WARNING: Never use this fan with any solid-state speed control device. Doing so will create fire and/or shock hazards.

APPLIANCE COMPONENTS



CAUTION: THIS FAN MUST OPERATE IN THE UPRIGHT POSITION ONLY. DO NOT LAY FAN ON ITS SIDE OR IN ANY OTHER POSITION. DOING SO MAY CAUSE DAMAGE TO THE FAN AND/OR PERSONAL PROPERTY. DO NOT USE THIS FAN WITHOUT ITS BASE.

FAN BASE ASSEMBLY

1. Remove all items of packing from the tower fan.
2. Pass the power cord through the middle of the two base pieces.
3. Position base piece onto the support posts of the other base piece to create the base assembly.
4. Turn the tower body upside down position the base assembly onto the pedestal tube. Ensure that the pedestal tube is sitting flush in the base assembly.

- Screw the base assembly onto the pedestal tube with the supplied 4pcs of screws.
- Position the power cord into the provided cord track in the rear base.
- Turn the tower fan back to upright position after assembled. It is now ready for use.

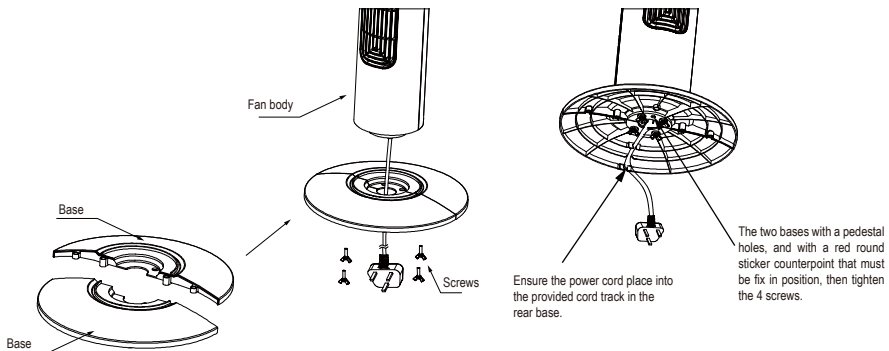

OPERATION

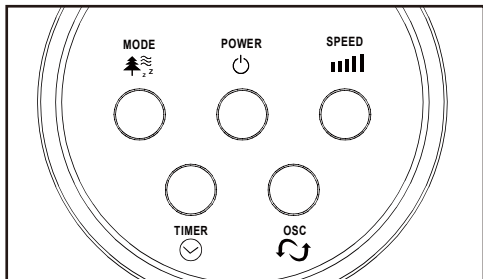

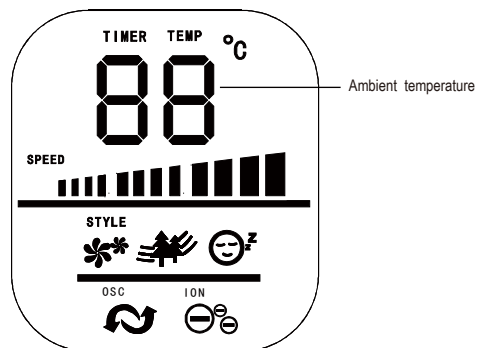

Control Panel



LED screen

The fan can be operated by the control panel located on the top of the Fan or by the remote controller(except Ionic function).

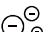
- Place the Fan on a stable and flat surface. Plug the power cord into a.c. 220 - 240V electrical outlet. The LED screen will display the current ambient temperature °C.
- POWER:** Turn the Fan ON by pressing the POWER button, the fan will start at Low speed .
- SPEED:** Adjust the Fan speed to the desired level: Low, Medium, or High by pressing SPEED button. The speed setting is displayed on the LED screen .
- MODE:** Press the MODE button to set the Fan as Normal , Natural , or Sleep mode.The mode is displayed on the LED screen.

5. OSC: Press the OSC  button to allow the Fan to oscillate the wind direction. To stop the oscillation, press the button again. The maximum angle is 70°.
6. ION: The Ionic function can only be selected from the remote controller. Press ION  button to operate with ionic air purifying function or press  button 3-5seconds of control panel to start the Ionizer for air purification..
The ION icon will be shown on the LED screen.
7. TIMER: Press the TIMER  button to set desired auto power off time. There are 12 hours intervals, from 1 hour to 12 hours.
8. Power save mode : when at the 'Sleep' mode or the 'Timer' setting is on, the main LED screen will be off automatically after 30 seconds, and you can press any button to turn on the LED screen again.

Remote Controller:

1. Remote controller can be stored at the back storage slot of the fan body.
2. Before using the remote controller, remove the plastic protection from the battery.
3. All the functions performed on the Remote Controller work identically to the main Control panel (except ionic function).
4. The remote controller uses battery(One battery of: CR2025 is included).



CLEANING & MAINTENANCE

- Always disconnect the fan from the mains by switching it off and removing the plug from the power outlet before cleaning.
- Do not allow water to penetrate into the motor during cleaning.
- It is advisable to use a neutral detergent and a soft cloth and to rub dry. Do not use solvents, acidic detergents, petrol or alcohol etc. to clean the plastic components, as these could cause deformed or damaged.
- Pack the fan in the original box and place it in a dry, well-ventilated place when it is not to be used for a long period of time.

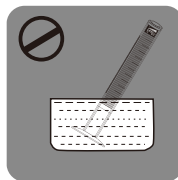

CAUTION



The  symbol on the product means that at the end of its life, the appliance must not be considered normal waste but hazardous waste and, as such, must be disposed of in specific recovery and disposal areas, as prescribed by the EC Directive 2002/96/EC (WEEE). By disposing of this product correctly, you can prevent negative consequences for the environment and for human health, due to the presence of potentially hazardous substances in the product.

TECHNICAL DATA

Model No. CTF38

Power supply: 220-240V~ 50/60Hz

Power: 45W

Product Dimensions: 315 x 315 x 960mm (with base)

Net Weight: 3.30kg

重要安全事項

注意: 當使用電動工具時, 應遵循基本的安全預防措施, 以減少火災, 觸電和人身傷害的風險, 包括以下內容:

首次操作本產品前, 先閱讀所有說明, 並保存各有指示:

1. 檢查銘牌上標示的電壓。本產品應在220-240V~50/60Hz的電力供應中使用。
2. 不要使用電源延長線。
3. 不要把你的手指穿過前方的出風口。不要讓孩子把任何異物插進前方的出風口。
4. 不要讓頭髮、窗簾、桌布、衣服或窗簾旁邊的物件放在的風扇的出風口。它們可能被吸入風扇內, 造成損壞或人身傷害。
5. 如風扇的電源線或插頭。在工作後、風扇跌落地或以任何方式損壞, 不要繼續使用。
6. 定期檢查風扇的電源線。如果電源線損壞, 必須由售後服務部或合格的電器技師更換, 以避免危險。
7. 不要在戶外使用這風扇。
8. 不要在潮濕的地方, 如浴室使用這風扇。
9. 不要在窗口附近使用這風扇。
10. 不要使用任何半導體速度控制器來控制這風扇。
11. 如沒有底座或把風扇橫放都不應操作。
12. 請勿覆蓋電源線。將電源線放於沒有任何絆倒風險下的位置。
13. 風扇不工作時, 請把插頭拔出。在拔走插頭前, 所有的開關必須是在“OFF”位置, 然後才把插頭拔除。
14. 不要在有汽油、油漆或易燃液體的地方使用。
15. 只使用本說明書中描述的方法使用這風扇。
16. 不要試圖拆開這風扇, 用戶不可以自行進行維修。如果您需要維修, 請送回售後服務中心處理。
17. 這風扇的所有部件或零件不可由用戶進行更換。
18. 如果電源線損壞, 必須由售後服務部或合格的電器技師更換。
19. 此風扇的安全技術標準是不可連接地線的。
20. 確保本風扇不可被兒童或體弱者接觸。不要讓他們在沒有監督下使用本產品。

注意：

1. 本產品不是為體質、感覺或智力有障礙人士（包括小孩）或缺乏經驗及知識者使用，除非他們曾經接受負責安全人士的監督或指導使用此電器。
2. 大人應該指導小孩不可把玩本電器。

注意：

這風扇沒有可由用戶進行更換的部分，用戶不可自行拆開風扇。

警告：

不要使用非本產品的控制器或硬物來控制這風扇，這會引致火警或觸電。

部件名稱



小心

該風扇僅在直立的位置使用。不要將風扇放側或打平使用。這樣做可能會對風扇造成損壞的和/或對個人做成損失。不要在沒有底座時使用這風扇。

底座安裝方法：

1. 移除所有包裝。
2. 把電源線穿過底座間的兩半圓位置。
3. 把兩塊底板相互扣緊。

4. 把電源線扣於底板指定位置上 (其中一塊底板設有電源線安全管道)。
5. 把風扇主體垂直放於底座上, 使用4枚螺絲將風扇主體及底座鎖緊。

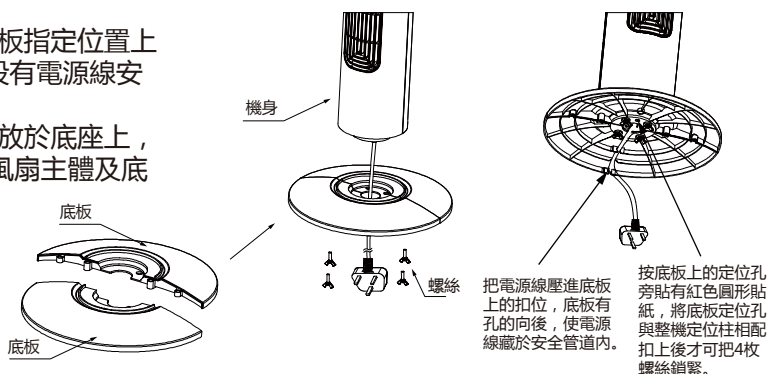

使用方法

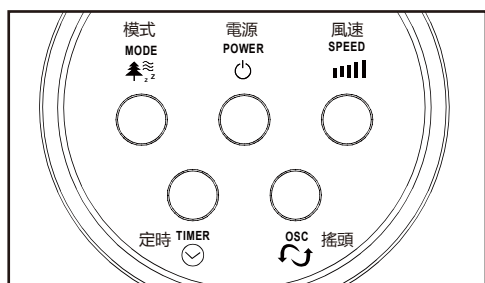

控制面板圖示

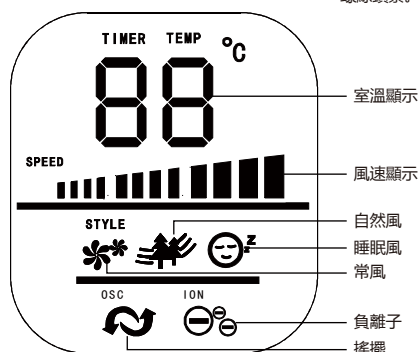

LED 顯示屏

風扇可使用機身頂部按鈕操控或用遙控器(負離子功能除外)操控亦可。

1. 將風扇擺放於穩固的平面上, 將插頭插入電壓220-240V的獨立插座。室內溫度(°C)顯示燈同時亮起。
2. 開/關(POWER): 按開/關 鍵, 風扇以低檔啟動。
3. 風速(SPEED): 按風速 設定鍵, 設定所需風速: 低、中和高檔。LED顯示屏將會顯示風速圖示。
4. 送風模式(MODE): 按送風模式鍵 設定所需送風模式: 常風 、自然風 和睡眠風 。LED顯示屏將會顯示送風模式。
5. 搖擺送風(OSC): 按下搖擺送風鍵 , 風扇以自動左右搖擺模式送風。如欲停止自動搖擺送風, 再按此鍵一次。最大角度為70°。
6. 負離子(ION): 此功能需在遙控器上選擇, 按下負離子 按鍵便可開啟負離子空氣淨化功能, 或者在控制面板上按 鍵3-5秒便可開啟負離子空氣淨化功能, 其顯示燈會於LED顯示屏上亮著。
7. 定時設置 (TIMER): 按下定時設置鍵 , 選定12個不同的自動關機時間, 分別由1至12小時, 並顯示於LED顯示屏。
8. 省電功能: 當設定了 '定時' 或 '睡眠' 模式時, LED顯示屏便會在30秒後自動熄滅。如要再次啟動顯示屏, 只要按下任何一個按鍵即可。

遙控器:

1. 遙控器收藏可於風扇背部；
2. 使用前將防漏電膠片拔掉；
3. 遙控器操控方式與機頂控制面板操控方式相同（負離子功能除外）；
4. 遙控器內已裝上一枚3伏特鋰電池（型號CR2025）。



清潔及保養

- 清理前必須先關掉本機並拔除電源插頭，切斷電源。
- 清理時切勿將此機浸於水或其他液體中。
- 可使用濕布加入少許溫和的清潔劑擦淨本產品。
- 切勿使用任何腐蝕性的物品洗刷本產品，因為可能因此損壞本產品的塑料部件。

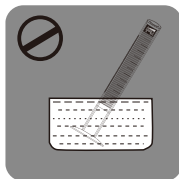

 本產品含有可回收材料，不可把本產品作為未分類廢物。
請聯繫就近指定回收點。

產品規格

型號：CTF38

電源：220-240V~50/60Hz

功率：45 瓦

產品尺寸：315x315x960毫米（連底座）

淨重重量：3.3公斤

請記錄下列產品資料

● 型號

● 機身編號

● 經銷商名稱

● 購買日期

本產品不斷改進中，如功能有所更改，恕不另行通知，如有疑問，請與客戶服務中心聯絡，不便之處，敬請原諒。

說明書內容以英文版本為準

ToolBox Customer Service Centre 客戶服務中心：

7/F., Goodwill Industrial Building, 36-44 Pak Tin Par Street, Tsuen Wan, N.T.
新界荃灣白田壩街36-44號信義工業大廈7樓

Customer Service Hotline 客戶服務熱線：(852) 8210 8210

Service E-mail 電郵地址：8210service@gilman-group.com

Please register now at 請即上網登記：www.toolbox.hk

Website 網址：www.gilman-group.com



Proudly Serviced by:



太平家庭電器

2/F, Shing Dao Industrial Building, 232 Aberdeen Main Road, Hong Kong
香港香港仔大道232號城都工業大廈2樓